

Tom Green County Commissioners’ Court  
October 22, 2002

The Commissioners’ Court of Tom Green County, Texas, met in Regular Session October 22, 2002 in the Edd B. Keyes Building, with the following members present:

- Clayton Friend, Commissioner of Precinct #1
- Karl Bookter, Commissioner of Precinct #2
- Jodie R. Weeks, Commissioner of Precinct #3
- Richard Easingwood, Commissioner of Precinct #4
- Michael D. Brown, County Judge

County Judge, Mike Brown, called the meeting to order at 8:34 AM.

The Pledge of Allegiance was recited and Commissioner Easingwood , offered the invocation.

4. Commissioner Easingwood moved to approve the Consent Agenda as presented. The motion was seconded by Commissioner Bookter:

- A. Approved the minutes, as amended, of the from the Regular Meeting, October 10, 2002 and from the Special Called Meeting October 14, 2002 as presented.
- B. Approved the Minutes of the Accounts Allowable from 10/ 9-15 /02 in the amount of \$912,335.43, and from 10/ 16-22 /02 in the amount of \$562,304.87 for a combined total of \$1,474,640.30; Purchase Orders from 10 / 7-11 /02 in the amount of \$180,939.70 and from 10/ 14-18 /02 in the amount of \$329.18 for a total of \$181,268.88.
- C. Accepted Personnel Actions as presented:

The following salary expenditures are being presented for your Approval:

<u>NAME</u>	<u>DEPARTMENT</u>	<u>ACTION</u>	<u>EFF. DATE</u>	<u>GRADE /STEP</u>	<u>SALARY</u>	
Ramirez, Adrian	Building Maintenance	New Hire	10/16/02	13/1	\$ 735.52	S/M
Hales, James R.	Jail	New Hire	10/10/02	16/1	\$ 852.90	S/M
Haubenstricker, Elena J.	Jail	New Hire	10/10/02	16/1	\$ 852.90	S/M
*Hind, Winona A.	Jail	Prom. & Transfer	10/14/02	12/1	\$ 699.98	S/M
Velez, Elsa M.	Jail	New Hire	10/21/02	16/1	\$ 852.90	S/M
Odum, Pandora	Library	New Hire	10/17/02	P/T	\$ 5.45	/HR
Mitcham, Ashley B.	Sheriff	Transfer	10/14/02	12/1	\$ 699.98	S/M

\* Went from Part-Time to Full-Time w/benefits

The following personnel actions are presented for Acknowledgement and as a matter of record:

<u>NAME</u>	<u>DEPARTMENT</u>	<u>ACTION</u>	<u>EFF. DATE</u>	<u>GRADE /STEP</u>	<u>SALARY</u>	
Carter, Scott S.	Jail	Resignation	10/15/02	16/1	\$ 852.90	S/M
O’Keeffe, Christopher K.	Jail	Resignation	10/25/02	16/1	\$ 852.90	S/M
Madrid, David P.	Road & Bridge 2/4	Resignation	10/16/02	13/1	\$ 735.52	S/M
Flanary, Shelley B.	CSCD (151)	Prom. & Transfer	10/16/02	N/A	\$1273.00	S/M
Martinez, John T.	CSCD (255)	Resignation	10/17/02	N/A	\$ 857.21	S/M
Ruiz, Trilce	CSCD (218)	New Hire	10/16/02	N/A	\$ 8.20	/HR

- D. Accepted the Extension Service Monthly Schedule of Travel as a matter of record. (Recorded with these minutes)
- E. Accepted the Collection’s report as a matter of record. (Recorded with these minutes).
- F. Acknowledged the following from Trinity Furniture’s portion of the Tom Green County Jail (Justice Center) project: (Recorded with these minutes)
  - 1. Subcontractor’s affidavit and conditional waiver of lien and conditional release.
  - 2. Contractor’s affidavit and final waiver of lien.
  - 3. Warranty
- G. Accepted the Solid Waste Report for September as a matter of record. (Recorded with these minutes)
- H. Approved Verizon Southwest’s request to construct a buried communication line within the right of way of a County road starting 1,662 feet south of the

intersection of W. Grape Creek Road on Ballard Road in the east right of way to bore and push a 2 inch GT 80 from right of way to right of way.

- I. Approved request by Concho Rural Water Corp. to install a water line in the west county right of way from the intersection of Line Road and FM 584 to supply service lines to Lots 10 – 14 in Southwest Acres Subdivision in Precinct # 2. (Recorded with these minutes)
- J. Approved request by Concho Rural Water Corp. to install a water line 80 feet along the County right of way on the west side of Willow Drive in Concho Estates Subdivision in Precinct #3. (Recorded with these minutes)

**All voted in favor.**

Commissioner Easingwood commented that only 5 people had utilized the Wall site for an average cost of about \$40.00 per person and 11 had utilized the Christoval site at a cost of approximately \$27.00 per user. Commissioner Friend commented that the collection of revenue for the use of the solid waste collection sites from 66 people created a loss of approximately \$1600.00 for the month of September. Commissioner Bookter commented that more and more of the citizens are using the private contractors which are the same people that the County has to pay to dispose of the trash that is deposited at the collection sites. Commissioner Weeks commented that with fewer collection sites, there might be more dumping on the highways and roadways which is already bad. They all agreed that they may need to look at other options regarding the collection sites.

5. Personnel Director, Milly Wilson, brought to the attention of the Court that the San Angelo ISD closed for Columbus Day and did not close for Veteran's Day. With the amount of single parents employed by the County, this creates a hardship because they have to take a sick day or vacation day in order to care for their children. This request for consideration of changing days was brought forth for this reason and to space out the holidays since there two other days in November. Judge Brown also stated that the banks and post offices are closed. He further stated that the Veteran's and others who were offended by this proposal, should also address the other taxing entities that do not recognize Veteran's Day.

**Commissioner Friend moved to amend the County Policy to add Columbus Day as an additional County Holiday and Veteran's Day will remain as a County holiday effective January 1, 2003. Commissioner Bookter seconded the motion. Commissioners Friend, Bookter and Easingwood and Judge Brown voted in favor. Commissioner Weeks voted in opposition to the motion stating that he felt there should not be any additional holidays added, but Veteran's Day should be left alone.**

Dr. Henry Ricci addressed the Court and stated that as a veteran he was offended that the County would even consider doing away with Veteran's Day as a holiday and as a day to honor all Veterans that had fought or died in World War I, World War II, the War in the Pacific, the Korean War, the Vietnam War or the Gulf War. He quoted the numbers of those who had lost their life in all of these conflicts. He felt that this was an insult to all Veterans. There were many others Veterans in attendance.

6. **Commissioner Weeks moved to accept the Treasurer's report for September, 2002 as presented. Commissioner Friend seconded the motion and all voted in favor.**

**Judge Brown moved to accept the Investment Report as presented. Commissioner Friend seconded the motion and all voted in favor.**

7. Susan Counts, Information Technology, reported that most of the super scout problems had been resolved and the internet was working well. She reported that they had received 56 work orders for the month of September. The computers for the District Court have been ordered and should have them installed in about 2 weeks after they arrive. There were a few problems with Microsoft shutting down Windows 2000 on some of the computers, but Cal-Tec is working on a patch for this and that should be resolved shortly. The IT Department is fully staffed at this time.
8. Sheriff Hunt reported that on the last Jail inspection, they received a gig for storing equipment in the main part of the jail. They were told to weld a bar on the double

doors and some other modifications to the trash compactor room, then that facility would be secure for storage of specialized equipment and could be utilized as an emergency or quick response staging area in the event of a riot or other problems. The equipment for the SRT team will be arriving soon and will have to be in a secure area. Once the equipment is in, there will be additional training utilizing the new equipment in the event of a lock-down or riot. There is money still available in the jail construction funds.

**Commissioner Bookter moved to allow the trash compactor room to be remodeled to meet jail standards and utilized as an emergency response room by the Special Response Team and used for storage of the Special Response equipment, subject to the bids and the approval by the maintenance department for modification of the doors and building based on the lowest bid and the cost to come out of jail construction funds. Commissioner Friend seconded the motion and all voted in favor.**

- 9. Judge Brown moved to approve the request by Sheriff Hunt for a part time Commissary Clerk to be paid through the County payroll system and the funds to be reimbursed to the County on a quarterly basis from the Jail Commissary Funds. Commissioner Weeks seconded the motion and all voted in favor.**
- 10. Commissioner Weeks moved to award the RFP 02-015 Cellular Phones to West Central Cellular at a monthly cost of \$17.95 per month per phone and authorize the Purchasing Agent (Johnny Grimaldo) to sign the one year agreements for each phone. Commissioner Easingwood seconded the motion and all voted in favor. (Bids recorded with these minutes)**
- 11. Commissioner Friend reported that he had received a call from a person reporting that law officials had been stopping and ticketing people on County roads for going 70 MPH on these roads. He explained to her and requested that the News media assist in getting the word out that on a non-posted County road the speed limit was 60 MPH and in a non-posted County residential area, the speed limit was 30 MPH. He also explained that signs had been posted in that area and had been knocked down or stolen or both, which was a prosecutable offense if caught. Commissioner Easingwood stated that the Dove Creek Homeowners Association had requested to have signs posted in their area. These were the items discussed pertaining to the Tom Green County Subdivision and Manufactured Home Rental Community Development Regulations. No Action was taken**

**12. There were no line item transfers.**

#### **Future Agenda Items:**

1. November 19, 2002 to discuss hazmat issues.

#### **Announcements:**

1. Early Voting has begun. Please GO VOTE!
2. Flu shots will be given for the County employees November 18<sup>th</sup>. Check your E-mail from Dianna Spieker for time and location.

**The meeting was adjourned at 9:42 AM.**

---

Michael D. Brown, County Judge

---

Elizabeth McGill, County Clerk and Ex-officio Clerk  
of the Commissioners' Court

**TEXAS AGRICULTURAL EXTENSION SERVICE**  
The Texas A&M University System

**MONTHLY SCHEDULE OF TRAVEL AND COUNTY COMMISSIONERS COURT REPORT**

<b>NAME: MARVIN ENSOR</b>	<b>TITLE: CEA-AG</b>
<b>COUNTY: Tom Green</b>	<b>MONTH: SEPTEMBER 2002</b>

DATE	MAJOR ACTIVITIES SINCE LAST REPORT	MILES	MEALS	LODGING
2	HOLIDAY			
3	PRESENTED REPORT TO FCS COMMITTEE			
4-5	ATTENDED TCE MENTOR TRAINING-COLLEGE STATION	727		
6-7	ASSIST 4-HERS AT WEST TX FAIR-ABILENE	374		
9	ATTENDED WEST TX BOYS RANCH PROGRAM	48		
10	PRESENTED PROPOSED RESOLUTION TO COMMISSIONERS COURT			
10	TASK FORCE MEETING OR COTTON FIELD DAY	18		
11	ASSISTED 4-HERS IN PREPARING BEEF CATTLE PROJECTS FOR SHOW-WALL	42		
12	OFFICE MGT			
13-14	ASSISTED 4-HERS AT WEST TX FAIR-ABILENE	378		
16	COMPLETED GRANT PROPOSAL FOR 4-H FACILITY			
17	AG MARKETING CLUB MEETING-WALL	27		
17	SUPERVISED 4-H LIVESTOCK PROJECTS	192		
18	WORKED ON COTTON FIELD DAY & SPONSORSHIPS			
19	PRESENTED PROGRAM AT VERIBEST ISD-VERIBEST	31		
20	SUPERVISED 4-H LIVESTOCK PROJECTS	162		
23	DISTRICT TRAINING & SPECIALIST SCHEDULING	24		
24	ASSISTED 4-H AGENT WITH NEW 4-H CLUB MEETING	29		
25	OFFICE MGT			
26	TOM GREEN COUNTY COTTON FIELD DAY	87		
27-28	ASSISTED 4-HERS AT SOUTH PLAINS FAIR-LUBBOCK	392		
31	STATE FAIR OF TEXAS	328		
GRAND TOTAL OF MILEAGE, MEALS & LODGING		2859	0	0

Other expenses (list) \_\_\_\_\_

I hereby certify this is a true and correct report of activities, travel and other expenses incurred by me in performance of official duties for the month shown.

## MONTHLY SCHEDULE OF TRAVEL AND COUNTY COMMISSIONERS COURT REPORT

NAME: JOHN BEGNAUD	TITLE: CEA-HORT
COUNTY: Tom Green	MONTH: SEPTEMBER 2002

DATE	MAJOR ACTIVITIES SINCE LAST REPORT	MILES	MEALS	LODGING
3,13,27,30	LANDSCAPE EVALUATIONS	326		
4,10,13,19	MASTER GARDENER PROJECTS	418		
5,12,19,26	TELEVISION	80		
5	PECAN MEETING	179		
6,7,9	NATIVE PLANT MEETING	85		
16	ASU LANDSCAPE & T.V. PROJECT	31		
17	RIO CONCHO WEST-LANDSCAPE EVALUATION	17		
18,19,20, 25,26	LANDSCAPE SCHOOL & PREPARATION	140		
GRAND TOTAL OF MILEAGE, MEALS & LODGING		1276	0	0

Other expenses (list) \_\_\_\_\_

I hereby certify this is a true and correct report of activities, travel and other expenses incurred by me in performance of official duties for the month shown.

## MONTHLY SCHEDULE OF TRAVEL AND COUNTY COMMISSIONERS COURT REPORT

NAME: BRANDON ASBILL	TITLE: CEA-4-H
COUNTY: Tom Green	MONTH: September 2002

[illegible]

Other expenses (list) \_\_\_\_\_

I hereby certify this is a true and correct report of activities, travel and other expenses incurred by me in performance of official duties for the month shown.

TEXAS AGRICULTURAL EXTENSION SERVICE  
The Texas A&M University System

MONTHLY SCHEDULE OF TRAVEL AND COUNTY COMMISSIONERS COURT REPORT

NAME: Kelly L. Ahrens	TITLE: CEA-FCS
COUNTY: Tom Green	MONTH: September 2002

DATE	MAJOR ACTIVITIES SINCE LAST REPORT	MILES	MEALS	LODGING
9/03	EEA Council, Leader Training, FCS Committee Meeting, TWC-BLT	10		
9/04-05	Extension Mentor Training, College Station	611		
9/06	TWC-BSSF Program, Food Protection Management Supplies	20		
9/09	Plaza del Sol Program Planning Meeting	16		
9/10	TWC-BSSF Prgm, Wall and Veribest EEA Meeting, FPM Supplies	85		
9/11	4-H Foods Leader Training, Office errands	14		
9/12	Grape Creek EEA Meeting, Fort Concho	35		
9/13	TWC-BLT Prgm, Shannon Medical Cntr, St. John's Hospital-FPM	10		
9/16	Community Medical Center, La Esperanza	18		
9/17	4-H Building Meeting, TWC Program, Goldstar Interviews-Runnels	75		
9/18	Foods Workshop Supplies	15		
9/19	Liveoak EEA Meeting	45		
9/20	Plaza del Sol, TWC-BSSF Program, Office Depot, Albertsons-FPM	36		
9/21	4-H Foods Workshop	16		
9/23	Administrative Meeting, District Office, BLT Prg Asst Party errands	26		
9/24	TWC-BLT Program, Farewell Party for BLT Program Assistant, FPM	18		
9/25	Food Protection Management	20		
9/26	EEA Rally Day, Fort Concho Meeting, FPM errands	35		
9/27	Food Protection Management	20		
9/30	Office errands, Plaza del Sol	27		
GRAND TOTAL OF MILEAGE, MEALS & LODGING		1152	0	0

Other expenses (list) \_\_\_\_\_

I hereby certify this is a true and correct report of activities, travel and other expenses incurred by me in performance of official duties for the month shown.

DATE: September 30, 2002		NAME: Kelly L. Ahrens		
CURRENT MONTHS CONTACTS				
TELEPHONE	OFFICE	SITE CONTACTS	NEWS ARTICLES	NEWSLETTERS
103	78	411	3=240,000	156
RADIO	TELEVISION	Mail/E-mail	PROGRAMS	TOTAL
		43	26=262	240,791

MAJOR PLANS FOR NEXT MONTH: October 2002	
DATE	ACTIVITY
1-4	BLT State Training, San Antonio
10/8	TWC Program
10/12	Multi-County 4-H Foods Workshop
10/15	TWC Program
10/17	Liveoak EEA
10/22	TWC Program
10/23	Program Planning Conference- Brady
10/24	Fort Concho Meeting
10/26	County 4-H Food Show
10/29	TWC Program



## **Tom Green County**

122 W. Harris Ave., San Angelo, Texas 76903  
(915) 659-6469 / (915) 659-3243 Fax



### **Collections Department Quarterly Activity Summary July – September 2002**

The Court data in this activity report reflects which Judge heard the case, not to which Court the case was assigned. Cases heard by a substitute Judge are assigned to the Judge being substituted for.

## *The Numbers for July - September 2002*

Cases Seen.....	302
CPF Issued.....	97
Late Notices Sent.....	807
Phone Calls Out.....	3905
Phone Calls In/Walk-Ins.....	1751

*Total revenues received by the County  
Clerk for criminal cases.*

*2002, 2001, 2000, 1999*

# Revenues

FY 1999 Revenues	FY 2000 Revenues	FY 2001 Revenues	FY 2002 Revenues
\$544,606.50	\$768,835.18	\$716,803.50	698,003.94
	41% Increase	32% Increase	28% Increase

Checks Collected Report  
Date Run: 10/16/2002, 10:48:50  
Date Range Selection: 07/01/2002 To 09/30/2002

Tom Green County Courts at Law  
Collections Department  
122 W. Harris Ave.  
San Angelo, Texas 76903-5877

TOTAL CASH \$161,263.25

GRAND TOTAL-Checks and Cash \$161,383.25

COURT BREAKOUT TOTALS	Category	Check	Cash	Total
County Court at Law	CCL#2			
	CR	0.00	80308.25	80308.25
County Court at Law	CCL			
	CR	120.00	80955.00	81075.00

*Total cases referred to collections by  
offense for the quarter by the Courts.*

# OFFENSE SUMMARY REPORT

For Cases With Sentencing Date From 07/01/2002 09/30/2002  
Court Number: CCL

Case Type	Total Cases	Amount Owed	Cash Paid	Jail/CSR Credit	Total Paid	Still Owed
ACBI	13	6957.25	1466.00	0.00	1466.00	5491.25
ALCO MINO	1	456.00	152.00	0.00	152.00	304.00
CM A/B	4	1869.00	749.00	0.00	749.00	1120.00
CRIM TR A	1	636.00	0.00	0.00	0.00	636.00
CRIM TR B	4	2204.00	623.00	0.00	623.00	1581.00
DWI	34	25195.00	6534.25	500.00	7034.25	18160.75
DWI 2ND	10	9242.50	3309.25	0.00	39025	5933.25
DWLS SR	14	6485.00	2055.25	200.00	2255.25	4229.75
EVADING B	3	1667.25	146.00	500.00	646.00	1021.25
FAIL2ID B	2	1171.25	356.00	0.00	356.00	815.25
INDECENT	1	486.00	83.00	0.00	83.00	403.00
INTR W/PD	2	947.00	0.00	0.00	0.00	947.00
MISDEMEAN	2	1017.00	781.00	0.00	781.00	236.00
MTRP	7	3389.25	2795.25	300.00	3095.25	294.00
POSS INHA	1	511.00	102.00	0.00	102.00	409.00
POSS MARJ	23	11539.25	5647.50	500.00	6147.50	5391.75
RECKLESS	1	480.25	480.25	0.00	480.25	0.00
RESIST AR	2	1047.00	204.00	0.00	204.00	843.00
THEFT 1	14	7003.25	2752.00	0.00	2752.00	4251.25
THEFT CKS	18	6259.00	1616.25	400.00	2016.25	4242.75
THEFTSERA	1	456.00	0.00	0.00	0.00	456.00
WEAPON P	3	2148.00	628.00	100.00	728.00	1420.00
-----						
Total Cases	161	91166.25	30480.00	2500.00	32980.00	58186.25

O F F E N S E   S U M M A R Y   R E P O R T

For Cases With Sentencing Date From 07/01/2002- 09/30/2002

Court Number: CCL#2

Case Type	Total Cases	Amount Owed	Cash Paid	Jail/CSR Credit	Total Paid	Still Owed
ACBI	16	7275.25	2266.00	0.00	2266.00	5009.25
ALCO MINO	1	461.00	461.00	0.00	461.00	0.00
CRIM TR A	1	436.00	25.00	0.00	25.00	411.00
CRIM TR B	4	1544.00	1196.00	0.00	1196.00	348.00
DWI	33	23088.50	7298.25	0.00	7298.25	15790.25
DWI 2ND	6	5655.25	1675.00	0.00	1675.00	3980.25
DWLS SR	17	7601.25	2623.00	200.00	28200	4778.25
EVADING A	1	235.25	118.00	0.00	118.00	117.25
FAIL2ID B	1	236.00	200.00	0.00	200.00	36.00
MISDEMEAN	2	746.25	510.25	0.00	510.25	236.00
MTRP	1	471.00	226.00	245.00	471.00	0.00
ODG POSS	1	611.00	138.00	0.00	138.00	473.00
POSS MARJ	19	9157.50	3664.00	400.00	4064.00	5093.50
RECKLESS	1	436.00	316.00	0.00	316.00	120.00
RESIST AR	4	2713.25	483.00	0.00	483.00	2230.25
THEFT 1	7	3071.25	1097.00	321.00	1418.00	1653.25
THEFT CKS	24	7304.00	2271.50	0.00	2271.50	5032.50
WEAPON P	2	696.25	276.00	300.00	576.00	120.25
-----						
Total Cases	141	71739.00	24844.00	1466.00	26310.00	45429.00

9

VOL. 75 pg. 480



**TOM GREEN COUNTY  
SUBCONTRACTOR'S AFFIDAVIT AND CONDITIONAL WAIVER OF LIEN  
AND CONDITIONAL RELEASE**

This is to certify that all obligations for labor and/or materials; all taxes, licenses, fees, and/or insurance and all other bills of whatever nature, which arose in any manner in connection with the performance of the contract between TRINITY FURNITURE (Subcontractor) and TEMPLETON CONSTRUCTION COMPANY on TOM GREEN CO JAIL PHASE III (Project) or any work performed by said subcontractor on said project from commencement of the work through the period ending \_\_\_\_\_, have been paid in full, and that there are no unsatisfied claims for such items or for injuries to persons and/or property occurring from or incident to the performance of said contract, except as follows:

Upon receipt of payment in the amount of \$20,861.05 for the period \_\_\_\_\_  
ending JUNE 20, 2002, TRINITY FURNITURE does hereby:  
(subcontractor)

(1) Waive and release any and all liens, mechanic liens or rights of such liens of whatever nature it may have on the above-described project, on account of labor and/or materials furnished through said period.

(2) Release and forever discharge TOM GREEN COUNTY., its bonding companies, if any, and the owner of the subject property of and from all debts, claims, demands, liabilities, and causes of action of every character whatsoever arising out of or in connection with said subcontract or any work performed by said subcontractor on said project except as follows: (There are no exception unless specific claims in stated amounts are listed.)

(3) Agree to hold harmless from any liability and to reimburse TOM GREEN COUNTY CO., its bonding companies, if any, and the owner of the subject property of and from all their costs, expenses, and reasonable attorney fees on any claims hereafter made in connection with said subcontract or any work performed by it on said project except as may be listed above.

This release may not be changed orally.  
EXECUTED at Temple, Tx  
(city & state)

on this 23 day of Sept, 2002

Attest: (If Corporation)

(Subcontractor)

By Opanna Swift Submgr.  
(Signature & Title)  
Jeanni Swift  
(Printed Name)

SEAL

SUBSCRIBED and sworn to before me by the said Jeanni Swift on this the 23  
day of Sept, A.D. 2002  
Naomi Lewis

Notary Public  
State of Texas  
Commission Expires: 12-06-04

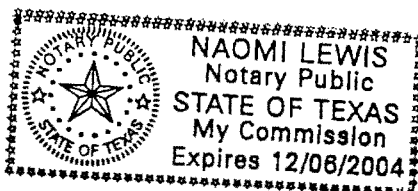

**TOM GREEN COUNTY  
CONTRACTOR'S AFFIDAVIT AND FINAL WAIVER OF LIEN**

This is to certify that all obligations for labor and/or materials; all taxes, licenses, fees, and/or insurance and all other bills of whatever nature, which arose in any manner in connection with the performance of the contract between TRINITY FURNITURE, Contractor, and **TOM GREEN COUNTY**, Owner, on the **TOM GREEN COUNTY JAIL JUSTICE CENTER**, (Project) or any work performed by said contractor on said project has been paid in full, and that there are no unsatisfied claims for such items or for injuries to persons and/or property occurring from or incident to the performance of said contractor.

In consideration and upon receipt of final payment of \$ 1,097.95, said contractor does hereby:

(1) Waive and release any and all liens, mechanic liens or rights of such liens of whatever nature it may have on the above-described project, on account of labor and/or materials furnished.

(2) Release and forever discharge TOM GREEN COUNTY, TEMPLETON CONSTRUCTION COMPANY, AND CZM ARCHITECTS, and their agents of and from all debts, claims, demands, liabilities, and causes of action of every character whatsoever arising out of or in connection with said contractor or any work performed by said contractor on said project.

3) Agree to hold harmless from any liability and to reimburse TOM GREEN COUNTY, TEMPLETON CONSTRUCTION COMPANY, AND CZM ARCHITECTS, for all of their costs, expenses, and reasonable attorney fees on any claims hereafter made in connection with said contractor or any work performed by it on said project except as may be listed above.

This release may not be changed orally.

EXECUTED at Temple, TX on this 23rd day of Sept, A.D. 2002  
(city & state)

Attest: (If corporation)

Trinity Furniture  
(Contractor)

By Jeanne Swift Salon Mgr.  
(Signature) (Title)  
Jeanne Swift  
(Printed Name)

(SEAL)

SUBSCRIBED and sworn to before me by the said Jeanne Swift on this the 23 day of Sept., A.D. 2002.

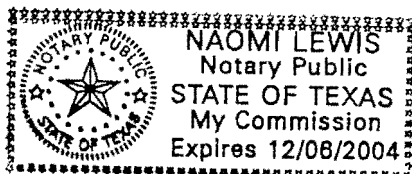

Naomi Lewis  
Notary Public  
State of Texas  
Commission Expires: 12-06-04

OWNER: TOM GREEN COUNTY

PROJECT: TOM GREEN COUNTY JUSTICE CENTER

We, TRINITY FURNITURE, the undersigned Contractor for the COURT ROOM BENCHES work on the above building, do hereby jointly and severally warrant that for a period of two (2) years from July 1, 2002, (Substantial Completion), the above work will be and will remain free from all defects not inherent in the quality required or permitted and that the work will conform to the requirements of the Contract Documents.

In the event of failure of materials, products or workmanship during the warranty period, we shall take appropriate measures to assure correction or replacement of the defective items. Items of work first performed after Substantial Completion shall have their warranties extended by the period of time between Substantial Completion and the actual performance of the Work. The warranty excludes remedy for damage or defect caused by abuse, modifications not executed by the Contractor, improper or insufficient maintenance, improper operation, or normal wear and tear and normal usage.

Trinity Furniture  
Contractor

By: Jeanne Swift

Jeanne Swift Sales Mgr.  
Printed Name and Title

Address: 2835 Lorraine Ave  
Ample, TX 76501

Phone: 866 886 6935

Fax: 866 888 7483

Warranty notification in writing may be provided by contacting the Contractor direct with a copy to Templeton Construction or by email to "warranty@templetonconstruction.com"

SEPTEMBER 2002  
**TGC SOLID WASTE REPORT**  
10/21/02

**WALL**

DATE	9-10am	10-11am	11-12am	12-1pm	TOTAL	CUSTOMERS
SEPT 7	1/\$20	1/\$20	1/\$10	0	\$50	3
SEPT 14	1/\$10	1/\$10	0	0	\$20	2
SEPT 21	0	0	0	0	0	0
SEPT 28	0	0	0	0	0	0

Salary	-\$96.00	WALL	SEPT 01	SEPT 2002	FY '02 TO DATE	FY 01 TO DATE
Duncan Disposal	-\$136.58	Expense	-\$526.50	-\$306.39	-\$4,153.01	-\$5,266.05
WTU	-\$5.86	Revenue	<u>\$136.00</u>	<u>\$70.00</u>	<u>\$1,050.00</u>	<u>\$1,290.00</u>
Cellular Phone	-\$ 17.95	Loss	-\$390.50	(\$236.39)	(\$3,103.01)	-\$3,976.05
Mrs. Its (land)	-\$ 50.00					
Total Expense	(\$306.39)					

**CHRISTOVAL**

DATE	11-12	12-1	1-2	2-3	3-4	4-5	TOTAL	Customers
SEPT 7	0	0	0	0	1/\$30	0	\$30	1
SEPT 14	1/\$10	1/\$10	1/\$27	1/\$10	0	0	\$57	4
SEPT 21	0	1/\$20	0	0	1/\$20	1/\$10	\$50	3
SEPT 28	1/\$15	1/\$20	0	1/\$20	0	0	\$55	3

Salary	-\$ 144.50	CHRISTOVAL	SEPT 01	SEPT 2002	FY '02 TO DATE	FY 01 TO DATE
Duncan Disposal	-\$305.73	EXP	-\$1,155.06	-\$475.86	-\$6,323.46	-\$6,426.37
WTU	-\$7.68	REV	<u>\$233.00</u>	<u>\$192.00</u>	<u>\$3,566.00</u>	<u>\$2836.00</u>
Cellular Phone	-\$ 17.95	LOSS	-\$922.06	(\$283.86)	-\$2,757.46	-\$3,590.37
Total Expense	(\$475.86)					

**GRAPE CREEK**

DATE	9-10	10-11	11-12	12-1	1-2	2-3	3-4	4-5	TOTAL	customers
SEPT 7	4/\$50	5/\$80	1/\$10	2/\$30	1/\$20	0	1/\$10	1/\$10	\$210	15
SEPT 14	3/\$84	4/\$50	1/\$20	0	0	1/\$20	2/\$20	1/\$10	\$204	12
SEPT 21	2/\$30	1/\$20	3/\$50	1/\$10	1/\$10	1/\$27	1/\$20	0	\$147	10
SEPT 28	4/\$77	1/\$20	2/\$20	0	2/\$20	2/\$20	2/\$20	0	\$157	13

Salary	-\$240.00	GRAPE CREEK	SEPT 01	SEPT 2002	FY '02 TO DATE	SAME PERIOD FY01
Duncan Disposal	-\$1,565.56	Expense	-\$2,857.58	-\$1,830.67	-\$24,555.10	-\$43,234.71
WTU	-\$7.16	Revenue	<u>\$1,890.00</u>	<u>\$718.00</u>	<u>\$12,578.00</u>	<u>\$16,303.00</u>
Cellular Phone	-\$ 17.95	LOSS	-\$969.58	-\$1,112.67	-\$11,977.10	-\$26,931.71
Total Expense	-( \$1,830.67)					

SEPT. 2002 SOLID WASTE COMPARISONS				
	SEPT 2001	SEPT. 2002	FY2002 TO DATE	SAME PERIOD FY01
EXPENSES	-\$4,541.14	-\$2,61292	-\$35,031.57	-\$54,927.13
REVENUE	<u>\$2,259.00</u>	<u>\$980.00</u>	<u>\$17,194.00</u>	<u>\$20,429.00</u>
LOSS TO DATE	-\$2,259.00	\$1,632.92	-\$17,837.57	-\$34,498.13

Water  
at Your  
Service



10/22/02  
*Agenda*

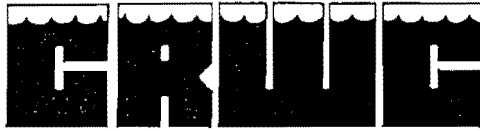

CONCHO RURAL WATER CORP.

Fax: (915) 658-2962

8174 Hwy. 87 N., SAN ANGELO, TEXAS 76901  
OFFICE: (915) 658-2961

Home: (915) 465-4692

July 22, 2002

Commissioners Court  
Tom Green County  
Karl W. Bookter  
Precinct 2

Dear Mr. Bookter

Concho Rural Water Corp., a public utility operating under CCN.# 11361 hereby request permission to install a 1" inch water line. The work location address is Line Road in Southwest Acres Subdivision Pct.2 Tom Green County. The work will begin at the Intersection of F.M. 584 and Line Rd. where service lines will be installed for lots 10,11,12,13,& 14 on the west side of Line Rd. A road cut will need to be made at each lot location as marked on the accompanying map. The locations are marked in green.

The Landowners have indicated that the Commissioner said the road could be cut to install the service lines. We will not do so until we have written approval from the County.

I have a copy of the adopted County construction regulations and specifications for Tom Green County. We will make every effort to comply.

Respectfully yours.

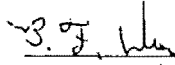
  
\_\_\_\_\_  
B. F. Wiese  
8174 Hwy 87N  
San Angelo, Texas 76901  
Ph. (915) 658-2961

103  
WASHINGTON CO. SCHOOL LAND

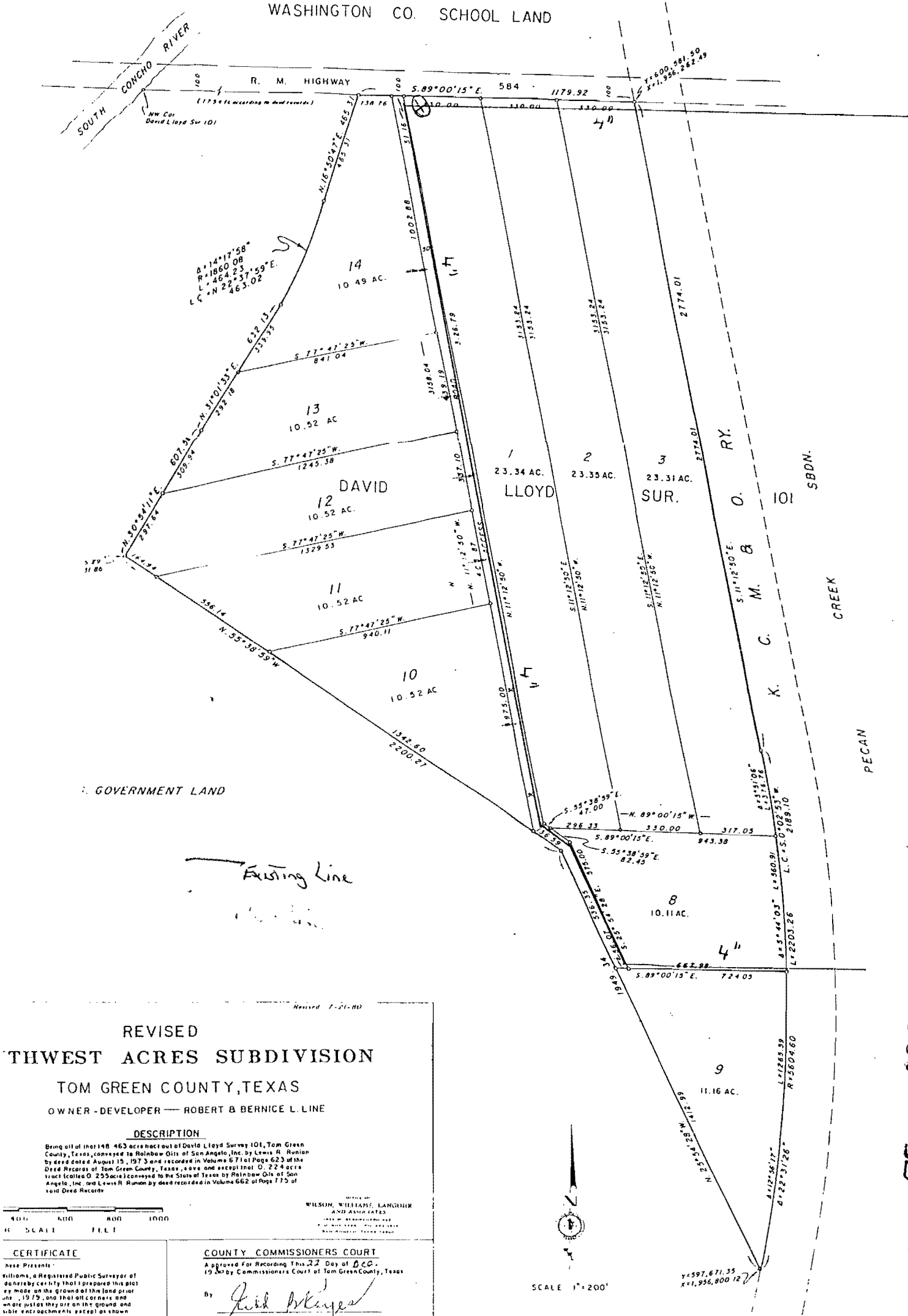

REVISED  
THWEST ACRES SUBDIVISION  
TOM GREEN COUNTY, TEXAS  
OWNER-DEVELOPER — ROBERT B BERNICE L LINE

**DESCRIPTION**  
Bring all of the 148.463 acre tract out of David Lloyd Survey 101, Tom Green County, Texas, conveyed to Rainbow Oaks of San Angelo, Inc. by Lewis R. Runion by deed dated August 15, 1973 and recorded in Volume 671 of Page 623 of the Deed Records of Tom Green County, Texas, and except that 0.224 acre tract (called O. 255) conveyed to the State of Texas by Rainbow Oaks of San Angelo, Inc. and Lewis R. Runion by deed recorded in Volume 662 of Page 775 of said Deed Records

**CERTIFICATE**  
I, the undersigned, a Registered Public Surveyor of and hereby certify that I prepared this plat as made on the ground at this land prior to 1975, and that all corners and whole parts they are on the ground and sub-encroachments except as shown

**COUNTY COMMISSIONERS COURT**  
Approved For Recording This 22 Day of Dec. 19 by Commissioners Court of Tom Green County, Texas

**SEAL OF OFFICE**  
WILSON, WILLIAMS, LANGRISH AND ASSOCIATES  
1975 M. BECKHOLDEN AVE.  
P.O. BOX 10000, FORT WORTH, TEXAS 76101

**AGENT OF OWNER**  
When of the above platted 148.24 Acres I adopt this plat as my subdivision of said

**COUNTY CLERK**  
Filed For Record This 23 Day of Dec. 19 by County Clerk, Tom Green County, Texas

SCALE 1"=200'

All courses and coordinates shown are those of the Texas Coordinate System - Central Zone

• = iron pipe

THE STATE OF TEXAS  
County of Tom Green  
do hereby certify that the above instrument of writing was filed for record in this office this 23 day of December 1975 at 1:02 o'clock P.M. and duly recorded the 31st day of December 1975 at 1:33 o'clock P.M. in the 148th record of said County, in Vol. 671 on page 215

Witness my hand and seal of office in San Angelo, Texas, the day and year last above written.

OWA JONES  
Deputy  
Clerk, County Court, Tom Green County, Texas

VOL. 75 PG. 486

Water  
at Your  
Service

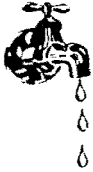

CONCHO RURAL WATER CORP.

Fax: (915) 658-2962

8174 Hwy. 87 N., SAN ANGELO, TEXAS 76901

Home: (915) 465-4692

OFFICE: (915) 658-2961

October 15, 2002

Commissioners Court  
Tom Green County  
Jodie Weeks  
Precinct 3

Dear Mr. Weeks:

Concho Rural Water Corp., a public utility operating under CCN.# 11361 hereby request permission to install a 2" inch Water line approximately 80' feet in length along the West side of Willow Dr. in Concho Estates Subdivision. No Boring will be necessary.

I have a copy of the adopted County construction regulations and specifications for Tom Green County. We will make every effort to comply.

Respectfully yours.

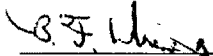

B. F. Wiese  
8174 Hwy 87N  
San Angelo, Texas 76901  
P853(915) 658-2961

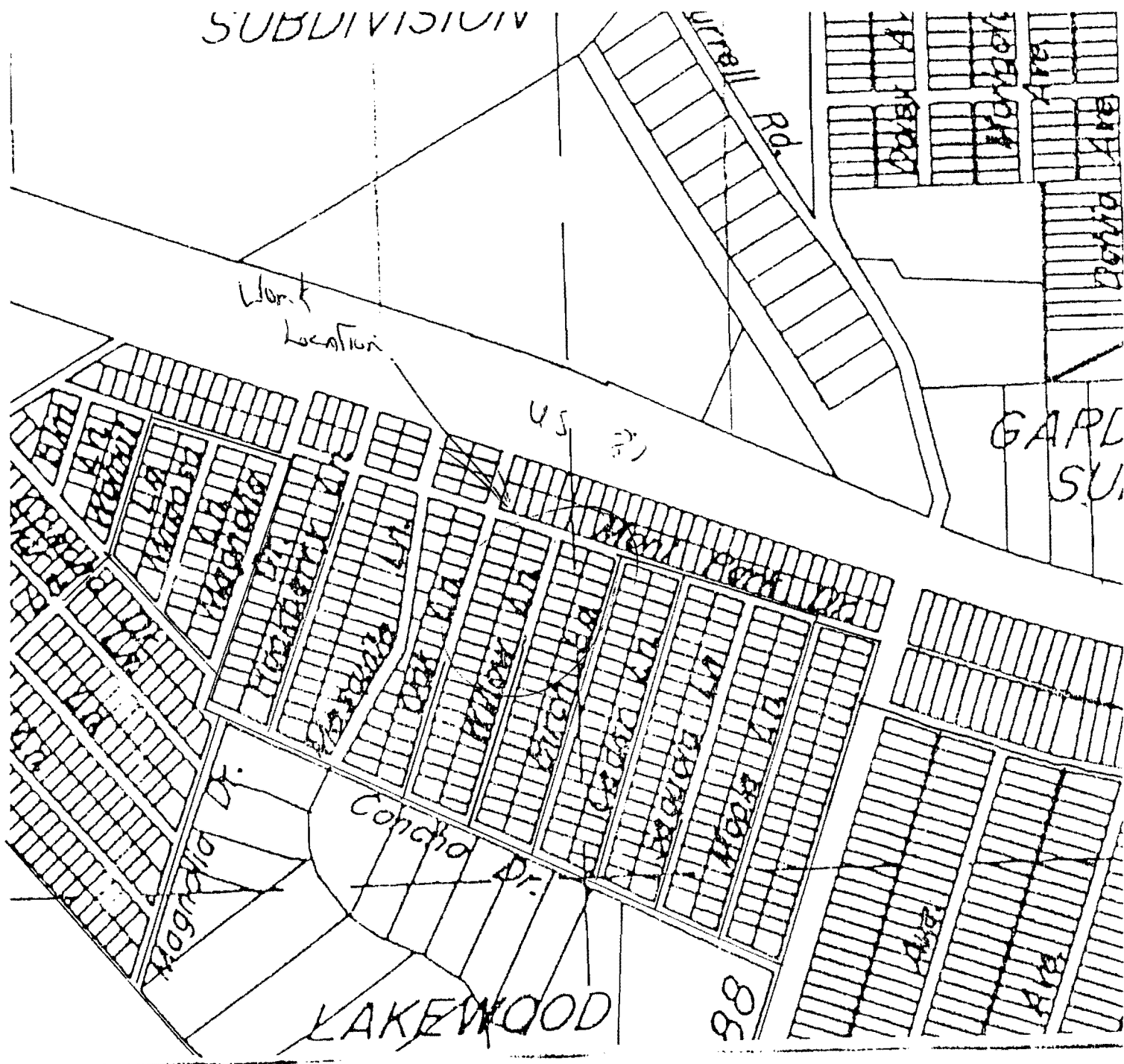

Existing Line

Proposed



Clerk

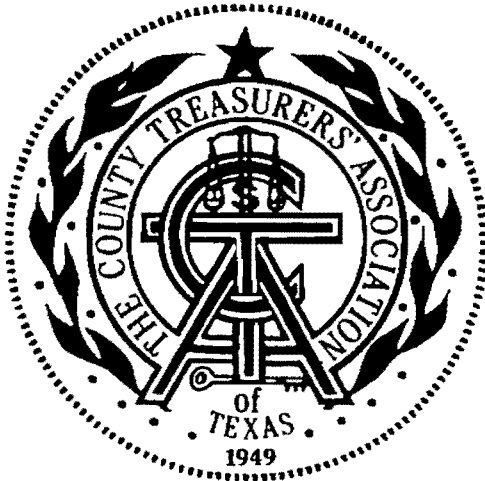

Dianna Spieker  
Tom Green County Treasurer

FY 2002 Monthly Report  
September 2002

THE STATE OF TEXAS ()

COUNTY OF TOM GREEN ()

Before me, the undersigned authority, on this day personally appeared Dianna Spieker, County Treasurer of Tom Green County, Texas, who being fully sworn, upon oath says that the within and foregoing report is true and correct to the best of her knowledge.

Filed with accompanying vouchers this the 22<sup>nd</sup> day of October, 2002

Dianna M Spieker  
Dianna Spieker, County Treasurer, Tom Green County

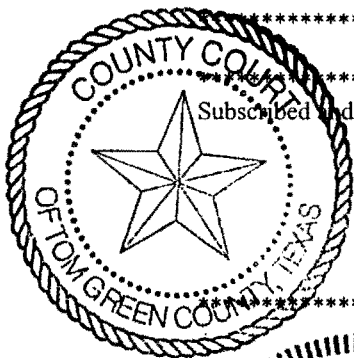

TOM GREEN COUNTY, TEXAS

Subscribed and sworn to before me on this the 22 day of October, 2002

Elizabeth McGill  
Elizabeth McGill, County Clerk, Tom Green County

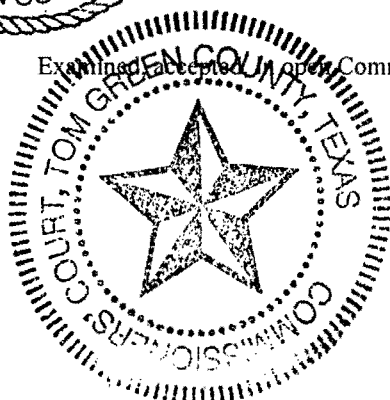

Examined and accepted in open Commissioners' Court this the 22<sup>nd</sup> day of October, 2002

Michael J. Brown  
Presiding Officer, Commissioners' Court

## *Tom Green County Treasurer Report*

### *Outline*

- 1) Recap Report
- 2) Texas State Bank
- 3) Funds Management
- 4) MBIA
- 5) Debt
- 6) Interest
- 7) Security

*Tom Green County*

*Fund Recap Report*

1) Recap. Report

# DEPOSIT REPORT PAGE 1 OF 3

#	FUND	Aug-02 BANK DEPOSITS	Sep-02 BANK DEPOSITS	Aug-02 MBIA	Sep-02 MBIA	Aug-02 FM	Sep-02 FM	Aug-02 SECURITIES	Sep-02 SECURITIES	Aug-02 TOTAL	Sep-02 TOTAL	Difference
001	GENERAL	\$94,268.88	\$145,986.62	\$1,959,878.41	\$1,680,025.38	\$2,767,383.95	\$2,771,023.69	\$993,362.07	\$996,982.76	\$5,814,893.31	\$5,594,018.45	(\$220,874.86)
001	Card Account	\$0.00	\$0.00									
005	R&B #1&3	\$6,946.84	\$5,900.85	\$329,737.91	\$280,267.52					\$336,684.75	\$286,168.37	(\$50,516.38)
006	R&B #2&4	\$7,167.49	\$6,634.74	\$603,410.32	\$534,318.09					\$610,577.81	\$540,952.83	(\$69,624.98)
009	CAFE	\$3,215.32	\$5,289.90							\$3,215.32	\$5,289.90	\$2,074.58
010	CO. LAW LIBR.	\$9,837.29	\$6,024.51	\$17,226.83	\$17,251.81	\$57,197.58	\$57,272.81			\$84,261.70	\$80,549.13	(\$3,712.57)
011	ZP-CAFE	\$2,500.00	\$2,500.00							\$2,500.00	\$2,500.00	\$0.00
012	JCTF	\$6,810.23	\$9,281.65	\$25,038.16	\$25,074.47					\$31,848.39	\$34,356.12	\$2,507.73
014	LIBR/HUGHES	\$185.44	\$186.44	\$1,530.84	\$1,533.06	\$464,918.24	\$465,529.71			\$466,634.52	\$467,249.21	\$614.69
015	LIBR DONATE	\$592.11	\$359.23	\$57,311.86	\$57,395.28					\$57,903.97	\$57,754.51	(\$149.46)
017	DC/RM	\$2,280.80	\$3,531.52	\$11,938.92	\$11,956.23					\$14,219.72	\$15,487.75	\$1,268.03
018	CRTHSE SEC	\$9,003.00	\$11,162.44	\$167,321.68	\$167,564.30					\$176,324.68	\$178,726.74	\$2,402.06
019	CC/RM	\$4,158.73	\$8,532.80	\$10,719.97	\$10,735.51					\$14,878.70	\$17,268.31	\$2,389.61
020	LIBR MISC	\$783.47	\$2,824.73	\$42,094.12	\$42,155.16					\$42,877.59	\$44,979.89	\$2,102.30
021	CIP DONATE	\$8,502.57	\$9,632.31							\$8,502.57	\$9,632.31	\$1,129.74
022	BATES	\$60.22	\$427.36	\$3,216.96	\$2,721.68	\$80,091.05	\$80,196.39			\$83,368.23	\$83,345.43	(\$22.80)
023	'92 I&S Closed	\$12,255.72	\$0.00							\$12,255.72	\$0.00	(\$12,255.72)
024	'93 I&S	\$1,963.37	\$40,976.76			\$102.31	\$102.45			\$2,065.68	\$41,079.21	\$39,013.53
025	GLP	\$106.93	\$107.51	\$9,961.36	\$9,975.80					\$10,068.29	\$10,083.31	\$15.02
027	TCDP	\$0.00	\$0.00							\$0.00	\$0.00	\$0.00
028	93 - A Closed	\$1,068.11	\$0.00							\$1,068.11	\$0.00	(\$1,068.11)
030	CC PRESERV	\$8,546.11	\$10,308.06	\$13,856.26	\$13,876.35					\$22,402.37	\$24,184.41	\$1,782.04
031	UNINSURED	\$31.26	\$31.43	\$6,893.50	\$6,903.50					\$6,924.76	\$6,934.93	\$10.17
035	CJP	\$131.52	\$163.08							\$131.52	\$163.08	\$31.56
036	FIN RESPON	\$75.00	\$75.00							\$75.00	\$75.00	\$0.00
037	COMP REHAB	\$20.23	\$35.01							\$20.23	\$35.01	\$14.78
038	WASTEWATER	\$1,183.82	\$913.82							\$1,183.82	\$913.82	(\$270.00)
039	'94 I&S	\$826.55	\$1,730.18			\$2,898.92	\$2,902.75			\$3,725.47	\$4,632.93	\$907.46
040	L.E.O.A	\$12.05	\$13.80							\$12.05	\$13.80	\$1.75
041	BREATH ALCO	\$14.17	\$20.65							\$14.17	\$20.65	\$6.48
042	L.E.M.I.	\$7.02	\$8.03							\$7.02	\$8.03	\$1.01
043	M.C.C.	\$28.85	\$30.34							\$28.85	\$30.34	\$1.49
044	'94 GNOB	\$17,198.75	\$0.00							\$17,198.75	\$0.00	(\$17,198.75)
045	CO ATTY	\$25,494.54	\$23,161.28							\$25,494.54	\$23,161.28	(\$2,333.26)
046	L.E.O.C.E.	\$22.66	\$25.90							\$22.66	\$25.90	\$3.24
047	JURY DONATE	\$37.00	\$37.00							\$37.00	\$37.00	\$0.00
048	ELECT CNTRCT	\$1,325.04	\$332.51							\$1,325.04	\$332.51	(\$992.53)
049	JE/CO JUDGE	\$1,584.59	\$1,577.50							\$1,584.59	\$1,577.50	(\$7.09)
050	51ST D.A. ST	\$9,852.13	\$10,100.73							\$9,852.13	\$10,100.73	\$248.60
051	LATERAL RDS	\$0.00	\$0.39							\$0.00	\$0.39	(\$0.39)
052	51ST D.A.	\$10,028.56	\$12,720.56							\$10,028.56	\$12,720.56	\$2,692.00
053	'95 CONSTR.	\$623,507.51	\$526,897.27							\$623,507.51	\$526,897.27	(\$96,610.24)
054	'95 I&S	\$289.30	\$567.64			\$2,240.83	\$2,243.79			\$2,530.13	\$2,811.43	\$281.30

VOL 75 pg 492

# DEPOSIT REPORT PAGE 2 OF 3

#	FUND	Aug-02 BANK DEPOSITS	Sep-02 BANK DEPOSITS	Aug-02 MBIA	Sep-02 MBIA	Aug-02 FM	Sep-02 FM	Aug-02 SECURITIES	Sep-02 SECURITIES	Aug-02 TOTAL	Sep-02 TOTAL	Difference
055	119TH DA ST	\$5,054.78	\$5,022.74							\$5,054.78	\$5,022.74	(\$32.04)
057	119TH DA DPS	\$2,953.46	\$2,956.88							\$2,953.46	\$2,956.88	\$3.42
058	119TH DA SPEC	\$17,401.10	\$13,039.65							\$17,401.10	\$13,039.65	(\$4,361.45)
059	PARKS	\$49.68	\$49.95							\$49.68	\$49.95	\$0.27
060	CVCA	\$26,939.30	\$42,188.44	\$13,132.02	\$13,132.02					\$40,071.32	\$55,320.46	\$15,249.14
061	OJP	\$259.01	\$260.41	\$3,315.09	\$3,319.90					\$3,574.10	\$3,580.31	\$6.21
062	CHAP	\$4,473.67	\$21,111.13							\$4,473.67	\$21,111.13	\$16,637.46
063	TAIP/CSC GRNT	\$11,393.46	\$70,725.97							\$11,393.46	\$70,725.97	\$59,332.51
064	D.T.P.	\$7,806.06	\$20,244.09							\$7,806.06	\$20,244.09	\$12,438.03
065	CSCD	\$26,305.94	\$209,362.80							\$26,305.94	\$209,362.80	\$183,056.86
066	CRTC	\$76,616.91	\$300,963.63							\$76,616.91	\$300,963.63	\$224,346.72
067	CCP	\$8,952.04	\$67,291.41							\$8,952.04	\$67,291.41	\$58,339.37
068	ARREST FEES	\$5,149.56	\$7,063.01	\$2,146.55	\$2,146.55					\$7,296.11	\$9,209.56	\$1,913.45
070	JE	\$3,018.91	\$4,636.08	\$1,361.88	\$1,361.88					\$4,380.79	\$5,997.96	\$1,617.17
071	ST & MPL FEES	\$7,898.10	\$6,207.61	\$18,068.19	\$18,068.19					\$25,966.29	\$24,275.80	(\$1,690.49)
072	CCC	\$31,182.12	\$49,383.70	\$15,906.09	\$15,906.09					\$47,088.21	\$65,289.79	\$18,201.58
073	GRAFFITI	\$354.37	\$366.29							\$354.37	\$366.29	\$11.92
074	TIME PAYMENTS	\$2,280.27	\$1,476.31	\$2,483.86	\$2,483.86					\$4,764.13	\$3,960.17	(\$803.96)
075	V.C.S.O.	\$3,294.64	\$3,518.98							\$3,294.64	\$3,518.98	\$224.34
076	EMPL ENRICH	\$7,541.18	\$7,866.31							\$7,541.18	\$7,866.31	\$325.13
077	FUGITIVE	\$7,586.10	\$11,664.29	\$3,555.02	\$3,555.02					\$11,141.12	\$15,219.31	\$4,078.19
078	INDIGENT	\$2,971.40	\$4,206.40	\$220.48	\$220.48					\$3,191.88	\$4,426.88	\$1,235.00
079	JCD	\$1,089.65	\$1,481.51							\$1,089.65	\$1,481.51	\$391.86
080	BOND	\$17.06	\$20.87							\$17.06	\$20.87	\$3.81
081	CMI	\$992.09	\$1,334.22							\$992.09	\$1,334.22	\$342.13
082	JUDICIAL	\$9,098.63	\$8,196.66							\$9,098.63	\$8,196.66	(\$901.97)
084	JDF	\$123,720.17	\$65,703.00							\$123,720.17	\$65,703.00	(\$58,017.17)
085	TXPC	\$495,522.04	\$470,033.27							\$495,522.04	\$470,033.27	(\$25,488.77)
086	TJP-TGC	\$19,896.31	\$33,199.87							\$19,896.31	\$33,199.87	\$13,303.56
087	TJP-DISC	\$60,543.69	\$56,358.38							\$60,543.69	\$56,358.38	(\$4,185.31)
088	CHILD TRUST	\$1,497.50	\$1,020.00							\$1,497.50	\$1,020.00	(\$477.50)
089	INFPS	\$32,441.42	\$27,856.66							\$32,441.42	\$27,856.66	(\$4,584.76)
090	REG/PS	\$31,119.84	\$31,162.03							\$31,119.84	\$31,162.03	\$42.19
091	TJP-COKE	\$30,049.28	\$29,580.30							\$30,049.28	\$29,580.30	(\$468.98)
092	CCP ASSIST	\$53,359.13	\$51,178.07							\$53,359.13	\$51,178.07	(\$2,181.06)
093	NRP	\$2,798.92	\$2,388.52							\$2,798.92	\$2,388.52	(\$410.40)
094	EFTPS	\$0.00	\$0.00							\$0.00	\$0.00	\$0.00
095	PAYROLL	\$3,060.61	\$3,664.74							\$3,060.61	\$3,664.74	\$604.13
096	C@L EXCESS	\$773.75	\$3,504.21							\$773.75	\$3,504.21	\$2,730.46
097	LEOSE/Sheriff	\$76.71	\$461.14	\$9,961.30	\$2,975.74					\$10,038.01	\$3,436.88	(\$6,601.13)
098	CRSFF	\$6,440.66	\$6,977.66							\$6,440.66	\$6,977.66	\$537.00
099	98IS	\$5,842.89	\$12,249.11			\$12,774.10	\$12,790.86			\$18,616.99	\$25,039.97	\$6,422.98
101	98 TAX IS	\$1,311.22	\$1,918.78			\$57.49	\$57.57			\$1,368.71	\$1,976.35	\$607.64

DEPOSIT REPORT PAGE 3 OF 3

#	FUND	Aug-02 BANK DEPOSITS	Sep-02 BANK DEPOSITS	Aug-02 MBIA	Sep-02 MBIA	Aug-02 FM	Sep-02 FM	Aug-02 SECURITIES	Sep-02 SECURITIES	Aug-02 TOTAL	Sep-02 TOTAL	Difference
102	Const 1 LEOSE	\$1,859.92	\$1,869.98							\$1,859.92	\$1,869.98	\$10.06
103	Const 2 LEOSE	\$423.33	\$425.62							\$423.33	\$425.62	\$2.29
104	Const 3 LEOSE	\$2,704.51	\$2,720.95							\$2,704.51	\$2,720.95	\$16.44
105	Const 4 LEOSE	\$2,901.43	\$2,404.57							\$2,901.43	\$2,404.57	(\$496.86)
106	Justice Courts	\$3,800.69	\$4,668.83	\$25,221.49	\$25,258.06					\$29,022.18	\$29,926.89	\$904.71
109	TCOM	\$8,508.99	\$23,945.04							\$8,508.99	\$23,945.04	\$15,436.05
110	JDPF	\$3,436.79	\$3,791.01							\$3,436.79	\$3,791.01	\$354.22
111	CJ EXCESS	\$491.35	\$5,800.73							\$491.35	\$5,800.73	\$5,309.38
201	Loanstar Libr	\$852.03	\$148.16							\$852.03	\$148.16	(\$703.87)
203	Lib Expansion	\$0.00	\$0.00							\$0.00	\$0.00	\$0.00
301	Landscape	\$602.62	\$605.88							\$602.62	\$605.88	\$3.26
401	Sheriff	\$1,344.28	\$1,345.84							\$1,344.28	\$1,345.84	\$1.56
500	State Aid/Regional	\$0.00	(\$3,677.74)							\$0.00	(\$3,677.74)	(\$3,677.74)
501	Sal Adj-Reg	\$0.00	(\$475.74)							\$0.00	(\$475.74)	(\$475.74)
502	Com Cor/Reg State	\$0.00	(\$5,866.33)							\$0.00	(\$5,866.33)	(\$5,866.33)
503	Com Cor/Reg	\$0.00	(\$719.06)							\$0.00	(\$719.06)	(\$719.06)
504	IV-E Prog Reg	\$0.00	\$0.00							\$0.00	\$0.00	\$0.00
505	Res Reg	\$0.00	\$0.00							\$0.00	\$0.00	\$0.00
580	AYUDAR Donations	\$0.00	\$0.00							\$0.00	\$0.00	\$0.00
581	Challenge Grant	\$0.00	\$4,925.00							\$0.00	\$4,925.00	\$4,925.00
582	TYC	\$0.00	(\$482.23)							\$0.00	(\$482.23)	(\$482.23)
583	IV-E Program	\$0.00	\$61,733.30							\$0.00	\$61,733.30	\$61,733.30
584	Post Adj	\$0.00	\$0.00							\$0.00	\$0.00	\$0.00
585	AYUDAR-Sub	\$0.00	\$11,278.41							\$0.00	\$11,278.41	\$11,278.41
586	State Aid	\$0.00	\$46,089.98							\$0.00	\$46,089.98	\$46,089.98
587	Comm Corr	\$0.00	\$37,103.14							\$0.00	\$37,103.14	\$37,103.14
588	Sal Adj	\$0.00	(\$5,648.45)							\$0.00	(\$5,648.45)	(\$5,648.45)
589	Fam Preserv	\$0.00	\$11,651.50							\$0.00	\$11,651.50	\$11,651.50
590	Post Adj State	\$0.00	\$62,050.00							\$0.00	\$62,050.00	\$62,050.00
TOTAL		\$2,037,982.75	\$2,769,692.24	\$3,355,509.07	\$2,950,181.93	\$3,387,664.47	\$3,392,120.02	\$993,362.07	\$996,982.76	\$9,774,518.36	\$10,108,976.95	\$334,458.59
										\$9,774,518.36	\$10,108,976.95	\$334,458.59

VOL.

75 Pg.

434

*Texas State Bank*

- 1) Collateral Statement
- 2) Treasurer Daily Balance

6

## Pledged Securities Listing

September 30, 2002

6

ID	Rept	Safekeeping Location	Cusip	Par	Description	Cpn	Maturity	Moody	S&P	F115	Book	Market	Gain/(Loss)
5403-Tom Green County													
115	xxx	T.I.B.	31359MEX7	2,000,000.00	FNMA NON-CALLABLE	6.50	8/15/04	Aaa	NR	AFS	2,079,643.38	2,153,221.68	73,578.30
109	xxx	T.I.B.	3129244H3	1,000,000.00	FHLMC (1X CALL 2/03)	4.13	2/14/05	x	x	AFS	1,000,000.00	1,006,000.34	6,000.34
108	xxx	T.I.B.	3133MLRK3	1,000,000.00	FHLB	4.00	2/15/05	x	x	AFS	998,168.71	1,030,618.84	32,450.13
118	xxx	T.I.B.	312925KC3	2,000,000.00	FHLMC (1X CALL 5/03)	4.38	5/9/05	x	x	AFS	1,996,944.41	2,021,323.36	24,378.95
103	xxx	T.I.B.	3136F0PM8	2,000,000.00	FNMA (1 X CALL 7/03)	7.00	7/2/07	x	x	AFS	2,030,572.75	2,064,147.24	33,574.49
8	xxx	T.I.B.	313610E29	37,959.73	FN COFI# 46053	4.11	3/1/17	NR	NR	AFS	38,676.59	38,054.63	-621.96
1	xxx	T.I.B.	31340CDB0	14,475.10	FH# 141898	9.50	8/1/17	NR	NR	AFS	14,475.10	14,475.10	0.00
13	xxx	T.I.B.	31362DPZ5	24,941.05	FN COFI# 58040	5.20	8/1/17	NR	NR	AFS	24,941.05	25,315.17	374.12
53	xxx	T.I.B.	31371HVM7	1,028,327.20	FN# 252720	7.50	8/1/29	NR	NR	AFS	1,024,055.77	1,086,170.62	62,114.85
98	xxx	T.I.B.	36225CPL4	923,959.28	G2# 80426	5.50	7/20/30	NR	NR	AFS	934,487.15	936,466.51	1,979.36
10,029,662.36											10,141,964.91	10,375,793.49	233,828.58
Total Deposit Balances												0.00	
Over/Under												10,375,793.49	

113 w BEAR LEASING

VOL. 75 Pg. 496



## DAILY BALANCE

BANK CODE

BANK ACCT

DATE

DAILY  
DEPOSITSDAILY  
EXPENDITURES

All Funds

Total From Funds

GENO  
490202

General (01)

GENO  
490202

F/M1&amp;3(05)

GENO  
490202

F/M2&amp;4(06)

BAI Fwd	\$0.00	\$0.00	\$9,774,518.36	\$9,774,518.36	\$94,268.88	\$6,946.84	\$7,167.49
BAI Fwd	\$0.00	\$0.00	\$9,774,518.36	\$9,774,518.36	\$94,268.88	\$6,946.84	\$7,167.49
03-Sep-02	\$35,428.38	\$0.00	\$9,809,946.74	\$9,809,946.74	\$109,026.03	\$16,394.64	\$16,615.29
04-Sep-02	\$163,612.61	\$65,460.87	\$9,908,098.48	\$9,908,098.48	\$162,789.61	\$16,400.48	\$16,615.29
Sept 5-6, 2002	\$109,441.90	\$173.00	\$10,017,367.38	\$10,017,367.38	\$218,374.82	\$16,548.80	\$16,743.03
09-Sep-02	\$46,210.89	\$4,232.99	\$10,059,345.28	\$10,059,345.28	\$240,661.25	\$16,608.57	\$16,868.64
10-Sep-02	\$57,102.24	\$283,609.35	\$9,832,838.17	\$9,832,838.17	\$100,083.55	\$13,907.17	\$10,932.28
11-Sep-02	\$22,649.99	\$651,097.68	\$9,204,390.48	\$9,204,390.48	\$19,857.55	\$22,830.89	\$20,664.46
12-Sep-02	\$849,835.70	\$0.00	\$10,054,226.18	\$10,054,226.18	\$30,873.98	\$22,830.89	\$20,664.46
13-Sep-02	\$87,903.46	\$0.00	\$10,142,129.64	\$10,142,129.64	\$106,097.52	\$22,830.89	\$20,664.46
16-Sep-02	\$23,040.17	\$0.00	\$10,165,169.81	\$10,165,169.81	\$119,104.39	\$22,830.89	\$20,664.46
17-Sep-02	\$462,077.58	\$259,608.87	\$10,367,638.52	\$10,359,530.19	\$414,591.95	\$26,779.46	\$11,067.54
18-Sep-02	\$23,123.22	\$0.00	\$10,390,761.74	\$10,382,653.41	\$427,678.92	\$26,779.46	\$11,067.54
19-Sep-02	\$194,270.28	\$368.94	\$10,584,663.08	\$10,576,554.75	\$602,172.18	\$29,788.70	\$30,519.55
20-Sep-02	\$61,358.22	\$0.00	\$10,646,021.30	\$10,637,912.97	\$645,658.73	\$29,788.70	\$30,519.55
23-Sep-02	\$55,332.30	\$197,780.15	\$10,503,573.45	\$10,495,784.75	\$572,475.58	\$19,094.16	\$20,207.97
24-Sep-02	\$30,412.65	\$1,820.29	\$10,532,165.81	\$10,524,377.11	\$566,577.60	\$26,537.26	\$25,743.47
25-Sep-02	\$41,721.96	\$0.00	\$10,573,887.77	\$10,566,099.07	\$596,064.57	\$26,537.26	\$25,743.47
Sept 26,27, 2002	\$63,944.93	\$174.00	\$10,637,658.70	\$10,629,870.00	\$647,768.51	\$26,860.21	\$26,066.42
30-Sep-02	\$270,138.75	\$798,820.50	\$10,108,976.95	\$10,108,976.95	\$1,159,286.62	\$5,900.85	\$7,659.74

VOL.

75 Pg. 497

8

CAFE 490628 Cafeteria (09)	(FM/MBIA) GENO 490202 CLL (10)	ZP 424846 ZP-CAFE (11)	GENO 490202 JCTF(12)	(FM) GENO 490202 Hughes (14)	GENO 490202 Libr Donations (15)	GENO 490202 DCRM (17)	GENO 490202 CCSEC (18)
\$3,215.32	\$9,837.29	\$2,500.00	\$6,810.23	\$185.44	\$592.11	\$2,280.80	\$9,003.00
\$3,215.32	\$9,837.29	\$2,500.00	\$6,810.23	\$185.44	\$592.11	\$2,280.80	\$9,003.00
\$3,215.32	\$9,837.29	\$2,500.00	\$6,810.23	\$185.44	\$592.11	\$2,280.80	\$9,003.00
\$2,211.59	\$10,047.29	\$2,500.00	\$6,810.23	\$185.44	\$592.11	\$2,280.80	\$9,136.11
\$2,211.59	\$10,117.29	\$2,500.00	\$6,873.33	\$185.44	\$592.11	\$2,280.80	\$9,372.27
\$2,207.93	\$11,135.62	\$2,500.00	\$7,197.08	\$186.44	\$593.73	\$2,493.87	\$9,896.57
\$2,048.68	\$7,745.87	\$2,500.00	\$7,280.00	\$186.44	\$398.72	\$2,638.87	\$9,088.17
\$1,199.71	\$7,253.72	\$2,500.00	\$7,280.00	\$186.44	\$398.72	\$2,638.87	\$8,825.95
\$4,083.96	\$7,253.72	\$2,500.00	\$7,436.48	\$186.44	\$398.72	\$2,638.87	\$9,103.46
\$4,083.96	\$7,533.72	\$2,500.00	\$7,538.36	\$186.44	\$398.72	\$3,231.52	\$9,558.56
\$4,083.96	\$7,673.72	\$2,500.00	\$7,961.01	\$186.44	\$398.72	\$3,231.52	\$10,013.27
\$4,083.96	\$7,673.72	\$2,500.00	\$8,010.82	\$186.44	\$398.72	\$3,231.52	\$8,534.34
\$4,083.96	\$8,583.72	\$2,500.00	\$8,033.87	\$186.44	\$398.72	\$3,391.52	\$9,026.38
\$3,653.31	\$8,583.72	\$2,500.00	\$8,190.26	\$186.44	\$398.72	\$3,391.52	\$9,163.05
\$3,653.31	\$8,723.72	\$2,500.00	\$8,331.13	\$186.44	\$398.72	\$3,391.52	\$9,386.22
\$3,653.31	\$4,928.97	\$2,500.00	\$8,611.13	\$186.44	\$359.23	\$3,391.52	\$9,834.62
\$2,423.32	\$4,963.97	\$2,500.00	\$8,682.38	\$186.44	\$359.23	\$3,391.52	\$10,019.54
\$2,423.32	\$5,748.97	\$2,500.00	\$8,682.38	\$186.44	\$359.23	\$3,531.52	\$10,256.97
\$5,289.90	\$5,888.97	\$2,500.00	\$8,878.13	\$186.44	\$359.23	\$3,531.52	\$10,533.50
\$5,289.90	\$6,024.51	\$2,500.00	\$9,281.65	\$186.44	\$359.23	\$3,531.52	\$11,162.24

GENO 490202 CCRM (19)	GENO 490202 Lib. Misc. (20)	GENO 490202 CIP (21)	(FM) GENO 490202 Bates Fund (22)	92IS Paid Off 426687 92 CERT.I & S (23)	93IS 426687 93 CERT.I&S (24)	GENO 490202 GLP (25)	TCDP TCDP (027)
\$4,158.73	\$783.47	\$8,502.57	\$60.22	\$12,255.72	\$1,963.37	\$106.93	\$0.00
\$4,158.73	\$783.47	\$8,502.57	\$60.22	\$12,255.72	\$1,963.37	\$106.93	\$0.00
\$4,302.92	\$1,030.04	\$8,502.57	\$60.22	\$12,255.72	\$1,963.37	\$106.93	\$0.00
\$4,609.02	\$1,125.79	\$8,502.57	\$60.22	\$13,925.78	\$2,294.64	\$106.93	\$0.00
\$4,755.22	\$1,399.98	\$8,547.31	\$60.62	\$13,965.83	\$2,300.95	\$107.51	\$0.00
\$5,038.54	\$421.50	\$8,547.31	(\$72.64)	\$13,965.83	\$2,300.95	\$107.51	\$0.00
\$5,038.54	\$421.50	\$9,032.31	\$427.36	\$13,965.83	\$2,300.95	\$107.51	\$0.00
\$5,196.65	\$568.65	\$9,032.31	\$427.36	\$13,965.83	\$2,300.95	\$107.51	\$0.00
\$5,470.75	\$568.65	\$9,032.31	\$427.36	\$13,965.83	\$2,300.95	\$107.51	\$0.00
\$5,596.03	\$930.77	\$9,032.31	\$427.36	\$13,965.83	\$2,300.95	\$107.51	\$0.00
\$5,596.03	\$1,115.30	\$9,032.31	\$427.36	\$13,965.83	\$2,300.95	\$107.51	\$0.00
\$5,845.44	\$1,232.45	\$9,032.31	\$427.36	\$13,965.83	\$2,300.95	\$107.51	\$0.00
\$5,845.44	\$1,394.25	\$9,032.31	\$427.36	\$13,965.83	\$2,300.95	\$107.51	\$0.00
\$5,919.46	\$1,578.89	\$9,032.31	\$427.36	\$15,114.68	\$2,535.29	\$107.51	\$0.00
\$6,021.68	\$1,572.57	\$9,032.31	\$427.36	\$15,114.68	\$2,535.29	\$107.51	\$0.00
\$6,099.04	\$1,891.89	\$9,032.31	\$427.36	\$15,114.68	\$2,535.29	\$107.51	\$0.00
\$6,198.58	\$2,015.09	\$9,632.31	\$427.36	\$15,114.68	\$2,535.29	\$107.51	\$0.00
\$6,300.24	\$2,545.08	\$9,632.31	\$427.36	\$15,114.68	\$2,535.29	\$107.51	\$0.00
\$6,532.80	\$2,824.73	\$9,632.31	\$427.36	\$0.00	\$10,776.76	\$107.51	\$0.00

\$15,114.68

\$15,114.68

\$1,181.75

\$22,145.04

CO93 Paid Off 426687 93-A I & S (28)	GENO 490202 CO. Clk. Pres. (30)	GENO 490202 UNINS. MTRST (31)	GENO 490202 CJP (35)	GENO 490202 Fin. Resp. (36)	GENO 490202 Comp Rehab (37)	GENO 490202 Wastewater (38)	94IS 426687 94 CERT.I&S (39)
\$1,068.11	\$8,546.11	\$31.26	\$131.52	\$75.00	\$20.23	\$1,183.82	\$826.55
\$1,068.11	\$8,546.11	\$31.26	\$131.52	\$75.00	\$20.23	\$1,183.82	\$826.55
\$1,068.11	\$8,546.11	\$31.26	\$131.52	\$75.00	\$20.23	\$1,323.82	\$826.55
\$1,068.11	\$9,186.11	\$31.26	\$131.52	\$75.00	\$20.23	\$1,323.82	\$826.55
\$1,135.41	\$9,826.11	\$31.26	\$131.52	\$75.00	\$20.23	\$1,323.82	\$1,359.11
\$1,138.99	\$10,284.98	\$31.43	\$131.52	\$75.00	\$20.23	\$1,323.82	\$1,361.40
\$1,138.99	\$10,824.98	\$31.43	\$131.52	\$75.00	\$20.23	\$863.82	\$1,361.40
\$1,138.99	\$10,824.98	\$31.43	\$131.52	\$75.00	\$20.23	\$863.82	\$1,361.40
\$1,138.99	\$11,394.98	\$31.43	\$131.52	\$75.00	\$20.23	\$863.82	\$1,361.40
\$1,138.99	\$12,169.98	\$31.43	\$135.53	\$75.00	\$25.81	\$863.82	\$1,361.40
\$1,138.99	\$12,554.98	\$31.43	\$135.53	\$75.00	\$25.81	\$863.82	\$1,361.40
\$1,138.99	\$12,554.98	\$31.43	\$135.53	\$75.00	\$25.81	\$863.82	\$1,361.40
\$1,138.99	\$14,009.98	\$31.43	\$139.76	\$75.00	\$35.01	\$863.82	\$1,361.40
\$1,138.99	\$14,009.98	\$31.43	\$139.76	\$75.00	\$35.01	\$863.82	\$1,361.40
\$1,181.75	\$14,389.98	\$31.43	\$140.49	\$75.00	\$35.01	\$863.82	\$1,730.18
\$1,181.75	\$7,658.06	\$31.43	\$140.49	\$75.00	\$35.01	\$863.82	\$1,730.18
\$1,181.75	\$8,218.06	\$31.43	\$140.49	\$75.00	\$35.01	\$863.82	\$1,730.18
\$1,181.75	\$8,743.06	\$31.43	\$160.49	\$75.00	\$35.01	\$863.82	\$1,730.18
\$1,181.75	\$9,128.06	\$31.43	\$160.49	\$75.00	\$35.01	\$913.82	\$1,730.18
\$0.00	\$10,308.06	\$31.43	\$7,658.06	\$75.00	\$35.01	\$913.82	\$1,730.18
\$1,181.75							

VOL. 75 Pg. 500

GENO 490202 LEOA (40)	GENO 490202 Breath Alcohol (41)	GENO 490202 L.E.M.I. (42)	GENO 490202 M.C.C. (43)	94GNOB Paid Off 426687 94 GNOB (44)	GENO 490202 County Atty (45)	GENO 490202 LEOCE (46)	GENO 490202 JURY (47)
\$12.05	\$14.17	\$7.02	\$28.85	\$17,198.75	\$25,494.54	\$22.66	\$37.00
\$12.05	\$14.17	\$7.02	\$28.85	\$17,198.75	\$25,519.67	\$22.66	\$37.00
\$12.05	\$14.17	\$7.02	\$28.85	\$17,198.75	\$25,519.67	\$22.66	\$37.00
\$12.05	\$14.17	\$7.02	\$28.85	\$20,086.43	\$25,519.67	\$22.66	\$37.00
\$12.05	\$14.17	\$7.02	\$28.85	\$20,141.94	\$29,490.67	\$22.66	\$37.00
\$12.05	\$14.17	\$7.02	\$28.85	\$20,141.94	\$28,122.68	\$22.66	\$37.00
\$12.05	\$14.17	\$7.02	\$28.85	\$20,141.94	\$24,709.21	\$22.66	\$37.00
\$12.05	\$14.17	\$7.02	\$28.85	\$20,141.94	\$24,709.21	\$22.66	\$37.00
\$12.23	\$15.46	\$7.11	\$28.85	\$20,141.94	\$26,142.57	\$22.97	\$37.00
\$12.23	\$15.46	\$7.11	\$28.85	\$20,141.94	\$26,142.57	\$22.97	\$37.00
\$12.23	\$15.46	\$7.11	\$28.85	\$20,141.94	\$23,805.24	\$22.97	\$67.00
\$12.66	\$20.65	\$7.32	\$29.29	\$20,141.94	\$23,805.24	\$23.31	\$67.00
\$12.66	\$20.65	\$7.32	\$29.29	\$20,141.94	\$23,805.24	\$23.31	\$67.00
\$12.80	\$20.65	\$7.39	\$29.66	\$22,145.04	\$23,805.24	\$23.60	\$67.00
\$12.80	\$20.65	\$7.39	\$29.66	\$22,145.04	\$23,430.77	\$23.60	\$37.00
\$12.80	\$20.65	\$7.39	\$29.66	\$22,145.04	\$23,550.77	\$23.60	\$37.00
\$13.80	\$20.65	\$7.89	\$29.66	\$22,145.04	\$26,619.26	\$25.60	\$37.00
\$13.80	\$20.65	\$7.89	\$29.66	\$22,145.04	\$26,619.26	\$25.60	\$37.00
\$13.80	\$20.65	\$8.03	\$30.22	\$0.00	\$23,145.04	\$25.90	\$37.00
				\$22,145.04			

101 75 pg 501

GENO 490202 Elections (48)	GENO 490202 JE/CO. Judge (49)	GENO 490202 51st DA CPFA (50)	GENO 490202 LAT RDS (51)	51ST 425060 51ST DA SPEC (52)	95CONSTR 416312 95 CONST (53)	95 I&S 426687 95 I&S (54)	GENO 490202 119th DA CPFA (55)
\$1,325.04	\$1,584.59	\$9,852.13	\$0.00	\$10,028.56	\$623,507.51	\$289.30	\$5,054.78
\$1,325.04	\$1,584.59	\$9,852.13	\$0.00	\$10,028.56	\$623,507.51	\$289.30	\$5,054.78
\$1,325.04	\$1,584.59	\$9,852.13	\$0.00	\$10,028.56	\$623,507.51	\$289.30	\$5,054.78
\$1,325.04	\$1,599.59	\$9,852.13	\$0.00	\$10,028.56	\$623,507.51	\$289.30	\$5,054.78
\$1,325.04	\$1,604.59	\$9,852.13	\$0.00	\$10,028.56	\$660,446.33	\$468.14	\$5,054.78
\$1,336.88	\$1,612.50	\$9,902.96	(\$0.39)	\$10,040.19	\$661,015.89	\$468.13	\$5,081.74
\$1,336.88	\$1,622.50	\$9,845.76	(\$0.39)	\$10,040.19	\$634,548.35	\$468.13	\$5,024.56
\$807.24	\$1,622.50	\$9,845.76	(\$0.39)	\$10,040.19	\$634,548.35	\$468.13	\$5,024.56
\$807.24	\$1,622.50	\$9,845.76	(\$0.39)	\$10,040.19	\$634,548.35	\$468.13	\$5,024.56
\$807.24	\$1,647.50	\$9,845.76	(\$0.39)	\$10,040.19	\$634,548.35	\$468.13	\$5,024.56
\$807.24	\$1,662.50	\$9,845.76	(\$0.39)	\$10,040.19	\$634,548.35	\$468.13	\$5,024.56
\$807.24	\$1,662.50	\$9,845.76	(\$0.39)	\$10,040.19	\$540,785.05	\$468.13	\$5,024.56
\$807.24	\$1,667.50	\$9,845.76	(\$0.39)	\$10,040.19	\$540,785.05	\$468.13	\$5,024.56
\$807.24	\$1,502.50	\$9,845.76	(\$0.39)	\$10,040.19	\$540,796.81	\$468.13	\$5,024.56
\$807.24	\$1,517.50	\$9,845.76	(\$0.39)	\$10,040.19	\$540,796.81	\$566.84	\$5,024.56
\$807.24	\$1,547.50	\$9,526.14	(\$0.39)	\$10,040.19	\$526,897.27	\$566.84	\$4,704.94
\$807.24	\$1,547.50	\$9,526.14	(\$0.39)	\$10,040.19	\$526,897.27	\$566.84	\$4,704.94
\$807.24	\$1,552.50	\$10,100.73	(\$0.39)	\$13,040.19	\$526,897.27	\$566.84	\$5,022.74
\$807.24	\$1,557.50	\$10,100.73	(\$0.39)	\$13,040.19	\$526,897.27	\$566.84	\$5,022.74
\$332.51	\$1,577.50	\$10,100.73	(\$0.39)	\$13,040.19	\$526,897.27	\$566.84	\$5,022.74

DPS	119	GENO	GENO	GENO	CSCD	TRAG-CSCD	TRAG-CSCD	TRAG-CSCD
407860	424994	490202	490202	490202	490210	490210	490210	
119th DA/DPS (57)	119TH DA/SPEC (58)	PARKS(59)	CVCA (60)	OJP(061)	CHAP(62)	TAIP/CSC GRANT (63)	DTP (64)	
\$2,953.46	\$17,401.10	\$49.68	\$26,939.30	\$259.01	\$4,473.67	\$11,393.46	\$7,806.06	
\$2,953.46	\$17,401.10	\$49.68	\$26,939.30	\$259.01	\$4,473.67	\$11,393.46	\$7,806.06	
\$2,953.46	\$17,401.10	\$49.68	\$27,139.20	\$259.01	\$4,803.67	\$11,865.01	\$7,806.06	
\$2,953.46	\$17,401.10	\$49.68	\$27,967.23	\$259.01	\$4,855.13	\$11,885.60	\$7,816.35	
\$2,956.88	\$17,421.28	\$49.95	\$29,423.79	\$260.41	\$4,855.13	\$11,885.60	\$7,816.35	
\$2,956.88	\$13,359.28	\$49.95	\$30,276.02	\$260.41	\$4,723.96	\$11,885.60	\$7,816.35	
\$2,956.88	\$13,359.28	\$49.95	\$30,276.02	\$260.41	(\$4,182.78)	\$9,495.11	\$5,520.07	
\$2,956.88	\$13,359.28	\$49.95	\$31,186.45	\$260.41	\$33,317.22	\$77,434.11	\$5,520.07	
\$2,956.88	\$13,359.28	\$49.95	\$33,381.69	\$260.41	\$33,317.22	\$77,434.11	\$5,520.07	
\$2,956.88	\$13,359.28	\$49.95	\$35,315.65	\$260.41	\$33,317.22	\$77,434.11	\$5,520.07	
\$2,956.88	\$13,359.28	\$49.95	\$35,502.46	\$260.41	\$33,307.72	\$74,608.11	\$5,364.49	
\$2,956.88	\$13,359.28	\$49.95	\$36,042.80	\$260.41	\$33,307.72	\$74,608.11	\$23,170.49	
\$2,956.88	\$13,359.28	\$49.95	\$36,726.16	\$260.41	\$33,139.48	\$74,608.11	\$23,170.49	
\$2,956.88	\$13,359.28	\$49.95	\$37,463.55	\$260.41	\$33,139.48	\$74,608.11	\$23,170.49	
\$2,956.88	\$13,039.65	\$49.95	\$38,646.18	\$260.41	\$32,500.48	\$73,841.11	\$23,170.49	
\$2,956.88	\$13,039.65	\$49.95	\$39,067.95	\$260.41	\$32,500.48	\$73,841.11	\$23,170.49	
\$2,956.88	\$13,039.65	\$49.95	\$39,269.61	\$260.41	\$32,500.48	\$73,841.11	\$23,170.49	
\$2,956.88	\$13,039.65	\$49.95	\$40,288.92	\$260.41	\$32,500.48	\$73,841.11	\$23,170.49	
\$2,956.88	\$13,039.65	\$49.95	\$40,288.92	\$260.41	\$32,500.48	\$73,841.11	\$23,170.49	

TRAG-CSCD 490210 DAP (65)	TRAG-CSCD 490210 CRTC (66)	TRAG-CSCD 490210 CCP (67)	GENO 490202 Arrest Fees (68)	GENO 490202 Justice Ed (70)	GENO 490202 MUNICIPAL FEES (71)	GENO 490202 CONSOL. CRT COST (72)
\$26,305.94	\$76,616.91	\$8,952.04	\$5,149.56	\$3,018.91	\$7,898.10	\$31,182.12
\$26,305.94	\$76,616.91	\$8,952.04	\$5,149.56	\$3,018.91	\$7,898.10	\$31,182.12
\$26,305.94	\$77,361.16	\$8,952.04	\$5,149.56	\$3,018.91	\$7,898.10	\$31,182.12
\$131,314.91	\$77,867.91	\$8,952.04	\$5,154.69	\$3,030.34	\$8,276.83	\$31,410.54
\$131,819.25	\$79,086.74	\$9,054.97	\$5,218.55	\$3,095.57	\$9,009.66	\$32,353.59
\$132,749.91	\$80,284.65	\$9,054.97	\$5,510.53	\$3,272.07	\$10,441.79	\$34,006.44
\$121,370.49	\$74,216.87	\$9,054.97	\$5,594.37	\$3,353.74	\$11,151.73	\$34,976.29
\$55,508.52	\$37,504.24	(\$4,115.40)	\$5,594.37	\$3,353.74	\$11,151.73	\$34,976.29
\$322,964.52	\$361,657.49	\$84,569.60	\$5,679.02	\$3,454.04	\$11,327.52	\$36,010.71
\$322,964.52	\$361,657.49	\$84,569.60	\$5,783.01	\$3,590.78	\$12,158.62	\$39,463.56
\$322,964.52	\$362,335.49	\$84,569.60	\$6,072.84	\$3,833.50	\$13,039.83	\$41,657.11
\$318,664.60	\$352,266.76	\$84,419.60	\$6,116.97	\$3,858.40	(\$890.35)	\$41,868.83
\$300,974.00	\$352,603.76	\$84,419.60	\$6,152.99	\$3,901.21	\$793.73	\$42,473.71
\$299,266.41	\$351,852.86	\$84,173.01	\$6,245.96	\$3,991.32	\$793.73	\$43,248.23
\$299,266.41	\$352,139.86	\$84,173.01	\$6,382.17	\$4,079.92	\$1,713.22	\$44,082.37
\$291,181.35	\$345,523.89	\$84,153.24	\$6,539.55	\$4,227.61	\$2,601.97	\$45,423.86
\$291,181.35	\$345,953.39	\$84,153.24	\$6,587.71	\$4,274.23	\$3,050.37	\$45,903.00
\$291,181.35	\$346,848.14	\$84,153.24	\$6,589.71	\$4,284.16	\$4,057.37	\$46,082.06
\$291,181.35	\$347,542.64	\$84,153.24	\$6,766.05	\$4,407.15	\$4,699.94	\$47,238.68
\$209,362.80	\$300,763.43	\$67,221.41	\$7,083.01	\$4,386.08	\$5,207.61	\$49,383.70

VOL.

75 PG. 504

15



GENO 490202 GRAFFITI (73)	GENO 490202 TIME PAYMENTS (74)	GENO 490202 V.S.C.O. (75)	GENO 490202 EMPL ENRICH (76)	GENO 490202 FUGITIVE (77)	GENO 490202 Indigent(78)	GENO 490202 JCD(79)	GENO 490202 Bond Fees (80)
\$354.37	\$2,280.27	\$3,294.64	\$7,541.18	\$7,586.10	\$2,971.40	\$1,089.65	\$17.06
\$354.37	\$2,280.27	\$3,294.64	\$7,541.18	\$7,586.10	\$2,971.40	\$1,089.65	\$17.06
\$354.37	\$2,343.60	\$3,294.64	\$7,541.18	\$7,614.62	\$3,001.40	\$1,092.39	\$17.06
\$354.37	\$2,517.77	\$3,459.72	\$7,541.18	\$7,784.25	\$3,015.40	\$1,107.34	\$17.06
\$356.29	\$2,819.36	\$3,477.23	\$7,581.38	\$8,228.01	\$3,298.40	\$1,149.22	\$17.06
\$356.29	\$3,191.49	\$3,477.23	\$7,581.38	\$8,433.16	\$3,508.40	\$1,166.92	\$17.06
\$356.29	\$3,191.49	\$3,448.22	\$7,581.38	\$8,433.16	\$3,508.40	\$1,166.92	\$17.06
\$356.29	\$3,264.89	\$3,448.22	\$7,581.38	\$8,683.93	\$3,512.40	\$1,190.78	\$17.06
\$356.29	\$4,116.83	\$3,631.39	\$7,914.27	\$9,032.28	\$3,560.40	\$1,233.25	\$17.47
\$366.29	\$4,461.81	\$3,631.39	\$7,914.27	\$9,641.23	\$3,586.40	\$1,290.79	\$17.47
\$366.29	\$4,486.81	\$3,577.99	\$7,716.31	\$9,703.51	\$3,588.40	\$1,297.02	\$17.47
\$366.29	\$4,660.38	\$3,577.99	\$7,716.31	\$9,809.43	\$3,800.40	\$1,306.13	\$18.32
\$366.29	\$4,883.95	\$3,577.99	\$7,716.31	\$10,037.23	\$3,804.40	\$1,327.29	\$18.32
\$366.29	\$5,013.81	\$3,577.99	\$7,716.31	\$10,262.51	\$3,832.40	\$1,347.69	\$18.32
\$366.29	\$431.96	\$3,577.99	\$7,716.31	\$10,634.33	\$3,869.40	\$1,384.35	\$18.32
\$366.29	\$591.43	\$3,577.99	\$7,866.31	\$10,750.79	\$3,888.40	\$1,395.39	\$18.32
\$366.29	\$721.31	\$3,577.99	\$7,866.31	\$10,773.22	\$4,063.40	\$1,397.23	\$20.32
\$366.29	\$1,060.97	\$3,577.99	\$7,866.31	\$11,085.78	\$4,099.40	\$1,425.82	\$20.32
\$366.29	\$1,477.61	\$3,318.78	\$7,866.31	\$64.22	\$4,206.40	\$1,481.51	\$20.32

GENO 490202 CMI(081)	GENO 490202 JUDICIAL(082)	TRAG-JUV 428825 JDF(84)	TRAG-JUV 428825 TXPC(85)	TRAG-JUV 428825 TGC/TJP (86)	TRAG-JUV 428825 TJP-DISC. (87)	GENO 490202 Child Trust (88)	TRAG-JUV 428825 TJPC/PROG.SANC(89)
\$992.09	\$9,098.63	\$123,720.17	\$495,522.04	\$19,896.31	\$60,543.69	\$1,497.50	\$32,441.42
\$992.09	\$9,098.63	\$123,720.17	\$495,522.04	\$19,896.31	\$60,543.69	\$1,497.50	\$32,441.42
\$992.09	\$9,098.63	\$124,586.42	\$495,522.04	\$19,896.31	\$60,543.69	\$1,497.50	\$32,441.42
\$994.76	\$9,098.63	\$60,372.56	\$495,522.04	\$19,896.31	\$60,543.69	\$1,590.50	\$32,441.42
\$1,007.78	\$9,098.63	\$60,372.56	\$495,552.91	\$19,947.77	\$60,543.69	\$1,652.50	\$32,441.42
\$1,047.20	\$9,146.65	\$60,739.69	\$497,329.34	\$20,069.33	\$60,769.86	\$1,683.50	\$32,561.52
\$1,062.06	\$9,146.65	\$59,057.64	\$467,351.64	\$19,025.57	\$59,245.29	\$1,838.50	\$32,489.06
\$1,062.06	\$8,804.09	\$58,859.14	\$464,685.39	\$11,553.93	\$57,973.86	\$1,838.50	\$32,489.06
\$1,084.71	\$8,804.09	\$58,859.14	\$482,651.67	\$11,553.93	\$57,973.86	\$1,882.00	\$32,489.06
\$1,100.87	\$8,804.09	\$58,859.14	\$482,651.67	\$11,553.93	\$57,973.86	\$1,944.00	\$32,489.06
\$1,155.02	\$8,804.09	\$58,859.14	\$482,651.67	\$11,733.93	\$57,973.86	\$1,990.50	\$32,489.06
\$1,161.25	\$8,804.09	\$58,859.14	\$536,276.64	\$11,733.93	\$57,973.86	\$400.00	\$32,489.06
\$1,168.97	\$8,804.09	\$61,339.39	\$536,276.64	\$11,733.93	\$57,973.86	\$570.50	\$32,489.06
\$1,188.50	\$7,720.24	\$59,347.54	\$528,192.31	\$10,687.41	\$57,760.38	\$570.50	\$27,856.66
\$1,206.79	\$7,720.24	\$59,347.54	\$528,192.31	\$10,687.41	\$57,760.38	\$617.00	\$27,856.66
\$1,242.96	\$7,720.24	\$63,949.97	\$520,991.99	\$10,466.92	\$51,885.30	\$694.50	\$27,856.66
\$1,253.43	\$8,196.66	\$63,949.97	\$520,991.99	\$25,706.88	\$55,086.95	\$741.00	\$27,856.66
\$1,254.82	\$8,196.66	\$63,949.97	\$520,991.99	\$25,706.88	\$55,086.95	\$849.50	\$27,856.66
\$1,280.60	\$8,196.66	\$65,504.50	\$520,991.99	\$25,706.88	\$55,086.95	\$880.50	\$27,856.66
\$1,334.22	\$8,196.66	\$65,703.00	\$520,991.99	\$25,706.88	\$55,086.95	\$1,020.00	\$27,856.66

12

TRAG-JUV 428825 REG/PROG.SANC(90)	TRAG-JUV 428825 TJP-COKE (91)	TRAG-JUV 428825 CCP Assist (92)	TRAG-JUV 428825 NRP (93)	EFTPS 421448 EFTPS(94)	PAYL 490237 Payroll (95)	GENO 490202 C@L EXCESS(096)	GENO 490202 LEOSE/Sheriff(097)
\$31,119.84	\$30,049.28	\$53,359.13	\$2,798.92	\$0.00	\$3,060.61	\$773.75	\$76.71
\$31,119.84	\$30,049.28	\$53,359.13	\$2,798.92	\$0.00	\$3,060.61	\$773.75	\$76.71
\$31,119.84	\$30,049.28	\$53,359.13	\$2,798.92	\$0.00	\$3,910.51	\$773.75	\$76.71
\$31,119.84	\$30,069.87	\$53,369.42	\$2,798.92	\$0.00	\$3,910.51	\$773.75	\$76.71
\$31,226.21	\$30,183.60	\$53,563.44	\$2,810.52	\$0.00	\$3,910.51	\$777.94	\$77.13
\$31,162.03	\$29,670.46	\$53,446.37	\$2,803.52	\$0.00	\$3,910.51	\$777.94	\$77.13
\$31,162.03	\$25,165.42	\$51,724.23	\$2,803.52	\$0.00	\$3,902.63	\$777.94	\$77.13
\$31,162.03	\$25,165.42	\$51,724.23	\$2,803.52	\$0.00	\$4,186.13	\$777.94	\$77.13
\$31,162.03	\$25,165.42	\$51,724.23	\$2,803.52	\$0.00	\$4,186.13	\$777.94	\$77.13
\$31,162.03	\$25,165.42	\$51,724.23	\$2,803.52	\$0.00	\$4,186.13	\$777.94	\$77.13
\$31,162.03	\$25,165.42	\$51,724.23	\$2,803.52	\$0.00	\$4,186.13	\$777.94	\$77.13
\$31,162.03	\$25,165.42	\$49,455.93	\$2,803.52	\$0.00	\$4,186.13	\$777.94	\$461.14
\$31,162.03	\$25,165.42	\$49,455.93	\$2,803.52	\$0.00	\$5,086.46	\$777.94	\$461.14
\$31,162.03	\$25,075.26	\$49,455.93	\$2,388.52	\$0.00	\$5,086.46	\$3,504.21	\$461.14
\$31,162.03	\$25,075.26	\$49,455.93	\$2,388.52	\$0.00	\$5,086.46	\$3,504.21	\$461.14
\$31,162.03	\$25,075.26	\$49,455.93	\$2,388.52	\$0.00	\$5,086.46	\$3,504.21	\$461.14
\$31,162.03	\$25,075.26	\$49,455.93	\$2,388.52	\$0.00	\$5,684.18	\$3,504.21	\$461.14
\$31,162.03	\$25,580.50	\$51,724.23	\$2,388.52	\$0.00	\$3,664.77	\$3,504.21	\$461.14

GENO 490202	98IS 426687	98TANIS 426687	Geno 490202	Geno 490202	Geno 490202	Geno 490202	Geno 490202
CRSFF(098)	98IS(099)	98 TAX IS (101)	Const 1 leose(102)	Const 2 leose(103)	Const 3 leose(104)	Const 4 leose(105)	Crt Trans Fee(106)
\$6,440.66	\$5,842.89	\$1,311.22	\$1,859.92	\$423.33	\$2,704.51	\$2,901.43	\$3,800.69
\$6,440.66	\$5,842.89	\$1,311.22	\$1,859.92	\$423.33	\$2,704.51	\$2,901.43	\$3,800.69
\$6,440.66	\$5,842.89	\$1,311.22	\$1,859.92	\$423.33	\$2,704.51	\$2,901.43	\$3,800.69
\$6,440.66	\$5,842.89	\$1,311.22	\$1,859.92	\$423.33	\$2,704.51	\$2,901.43	\$3,800.69
\$6,492.16	\$9,505.03	\$1,658.53	\$1,859.92	\$423.33	\$2,704.51	\$2,901.43	\$3,836.64
\$6,518.16	\$9,521.00	\$1,662.62	\$1,869.98	\$425.62	\$2,720.95	\$2,917.13	\$4,011.40
\$6,525.66	\$9,521.00	\$1,662.62	\$1,869.98	\$425.62	\$2,720.95	\$2,917.13	\$3,584.73
\$6,525.66	\$9,521.00	\$1,662.62	\$1,869.98	\$425.62	\$2,720.95	\$2,917.13	\$3,584.73
\$6,577.16	\$9,521.00	\$1,662.62	\$1,869.98	\$425.62	\$2,720.95	\$2,917.13	\$3,669.20
\$6,650.16	\$9,521.00	\$1,662.62	\$1,869.98	\$425.62	\$2,720.95	\$2,917.13	\$3,722.26
\$6,650.16	\$9,521.00	\$1,662.62	\$1,869.98	\$425.62	\$2,720.95	\$2,917.13	\$3,953.41
\$6,726.66	\$9,521.00	\$1,662.62	\$1,869.98	\$425.62	\$2,720.95	\$2,917.13	\$3,978.31
\$6,791.66	\$9,521.00	\$1,662.62	\$1,869.98	\$425.62	\$2,720.95	\$2,917.13	\$3,997.42
\$6,791.66	\$9,521.00	\$1,662.62	\$1,869.98	\$425.62	\$2,720.95	\$2,404.57	\$4,086.51
\$6,863.16	\$12,249.11	\$1,918.78	\$1,869.98	\$425.62	\$2,720.95	\$2,404.57	\$4,168.36
\$6,863.16	\$12,249.11	\$1,918.78	\$1,869.98	\$425.62	\$2,720.95	\$2,404.57	\$4,308.36
\$6,893.16	\$12,249.11	\$1,918.78	\$1,869.98	\$425.62	\$2,720.95	\$2,404.57	\$4,347.68
\$6,893.16	\$12,249.11	\$1,918.78	\$1,869.98	\$425.62	\$2,720.95	\$2,404.57	\$4,347.68
\$6,914.66	\$12,249.11	\$1,918.78	\$1,869.98	\$425.62	\$2,720.95	\$2,404.57	\$4,458.59
\$6,977.66	\$12,249.11	\$1,918.78	\$1,869.98	\$425.62	\$2,720.95	\$2,404.57	\$4,688.59

TRAG-CSCD 490210 TCOMI(109)	TRAG-JUV 428825 JDPF(110)	Geno 490202 Co Judge Excess (111	Geno 490202 Loanstar Libr (201)	Geno 490202 Landscaping (301)	DA 428833 Sheriff Forfeiture (401)	TJP-COKE 428825 (500)
\$8,508.99	\$3,436.79	\$491.35	\$852.03	\$602.62	\$1,344.28	\$0.00
\$8,508.99	\$3,436.79	\$491.35	\$852.03	\$602.62	\$1,344.28	\$0.00
\$8,508.99	\$3,436.79	\$491.35	\$852.03	\$602.62	\$1,344.28	\$0.00
\$8,529.58	\$3,436.79	\$491.35	\$852.03	\$602.62	\$1,344.28	\$0.00
\$8,529.58	\$3,447.43	\$494.01	\$860.18	\$605.88	\$1,345.84	\$0.00
\$8,529.58	\$3,441.01	\$494.01	\$348.46	\$605.88	\$1,345.84	\$0.00
\$4,266.37	\$3,441.01	\$494.01	\$348.46	\$605.88	\$1,345.84	\$0.00
\$32,049.37	\$3,441.01	\$494.01	\$348.46	\$605.88	\$1,345.84	\$0.00
\$32,049.37	\$3,441.01	\$494.01	\$348.46	\$605.88	\$1,345.84	\$0.00
\$32,049.37	\$3,791.01	\$494.01	\$348.46	\$605.88	\$1,345.84	\$0.00
\$30,460.37	\$3,791.01	\$494.01	\$348.46	\$605.88	\$1,345.84	(\$170.95)
\$30,460.37	\$3,791.01	\$494.01	\$348.46	\$605.88	\$1,345.84	(\$170.95)
\$30,460.37	\$3,791.01	\$494.01	\$348.46	\$605.88	\$1,345.84	(\$335.48)
\$30,460.37	\$3,791.01	\$5,800.73	\$348.46	\$605.88	\$1,345.84	(\$335.48)
\$30,460.37	\$3,791.01	\$5,800.73	\$148.16	\$605.88	\$1,345.84	(\$335.48)
\$30,460.37	\$3,791.01	\$5,800.73	\$148.16	\$605.88	\$1,345.84	(\$335.48)
\$30,460.37	\$3,791.01	\$5,800.73	\$148.16	\$605.88	\$1,345.84	(\$335.48)
\$30,460.37	\$3,791.01	\$5,800.73	\$148.16	\$605.88	\$1,345.84	(\$335.48)
\$23,945.01	\$5,491.01	\$5,800.73	\$148.16	\$605.88	\$1,345.84	(\$335.48)

VOL. 75 pg. 509

20





Post Adj Facility  
428825

(590)	Securities	MBIA	Funds Management	Credit Card	Clearing Acct
\$0.00	\$993,362.07	\$3,355,509.07	\$3,387,664.47		\$0.00
\$0.00	\$993,362.07	\$3,355,509.07	\$3,387,664.47		\$0.00
\$0.00	\$993,362.07	\$3,355,509.07	\$3,387,664.47		\$0.00
\$0.00	\$993,362.07	\$3,355,509.07	\$3,387,664.47		\$0.00
\$0.00	\$993,362.07	\$3,355,509.07	\$3,387,664.47		\$0.00
\$0.00	\$993,362.07	\$3,360,681.93	\$3,392,120.02		\$0.00
\$0.00	\$993,362.07	\$2,950,181.93	\$3,392,120.02		\$0.00
\$0.00	\$993,362.07	\$2,950,181.93	\$3,392,120.02		\$0.00
\$0.00	\$993,362.07	\$2,950,181.93	\$3,392,120.02		\$0.00
\$0.00	\$993,362.07	\$2,950,181.93	\$3,392,120.02		\$0.00
\$0.00	\$993,362.07	\$2,950,181.93	\$3,392,120.02		\$0.00
\$0.00	\$993,362.07	\$2,950,181.93	\$3,392,120.02		\$0.00
\$0.00	\$993,362.07	\$2,950,181.93	\$3,392,120.02		\$0.00
\$0.00	\$993,362.07	\$2,950,181.93	\$3,392,120.02		\$0.00
\$0.00	\$993,362.07	\$2,950,181.93	\$3,392,120.02		\$0.00
\$0.00	\$993,362.07	\$2,950,181.93	\$3,392,120.02		\$0.00
\$0.00	\$993,362.07	\$2,950,181.93	\$3,392,120.02		\$0.00
\$0.00	\$993,362.07	\$2,950,181.93	\$3,392,120.02		\$0.00
\$0.00	\$993,362.07	\$2,950,181.93	\$3,392,120.02		\$0.00
\$62050.00	\$996,982.76	\$2,950,181.93	\$3,392,120.02		\$0.00

VOL. 75 Pg. 512

23



*Funds Management*  
*Bob Ross*  
*Joan Alexander*

- 1) Portfolio Statement
- 2) Treasurer Daily Balance
- 3) Interest Rates

24

**INVESTORS CASH TRUST - GOVERNMENT SECURITIES PORTFOLIO**  
**September 30, 2002**

<b>CATEGORY OF HOLDINGS</b>	<b>ISSUE RATE</b>	<b>ISSUE DUE DATE</b>	<b>PURCHASE RATE</b>	<b>DUE DATE</b>	<b>PAR VALUE</b>	<b>BOOK VALUE</b>	<b>% OF TOTAL</b>
<b><u>TREASURIES</u></b>							
US TREASURY BILLS		10/17/02	1.5700%	10/17/02	\$40,000,000.00	\$39,972,177.78	9.5390%
<b>TOTAL TREASURY SECURITIES</b>					<b>\$40,000,000.00</b>	<b>\$39,972,177.78</b>	<b>9.5390%</b>
<b><u>AGENCIES</u></b>							
FHLB FRN (1M L-13)	1.6930%	02/14/03	1.6930%	10/14/02	\$10,000,000.00	\$9,998,921.66	2.3862%
FHLB FRN (1M L-12.25)	1.6970%	02/26/03	1.6975%	10/26/02	\$7,500,000.00	\$7,498,892.01	1.7896%
FHLB FRN (1M L-13.25)	1.6800%	03/06/03	1.6800%	10/06/02	\$5,000,000.00	\$4,998,891.00	1.1929%
FHLB (PRIME-301 BP)	1.7390%	12/27/02	1.7400%	10/01/02	\$20,000,000.00	\$19,998,133.31	4.7724%
FEF FARM CREDIT BANK	4.3750%	05/01/03	2.0700%	05/01/03	\$11,000,000.00	\$11,145,202.85	2.6597%
FARM CREDIT (PRIME-302.5 BP)	1.7250%	06/02/03	1.7250%	10/01/02	\$10,000,000.00	\$9,998,386.52	2.3860%
FHLB FRN (1M L-14.75)	1.6720%	01/17/03	1.6725%	10/17/02	\$15,000,000.00	\$14,998,580.66	3.5793%
FHLB FRN (1M L-14)	1.6730%	03/24/03	1.6737%	10/24/02	\$5,000,000.00	\$4,998,812.75	1.1929%
FED HOME LOAN BANK	5.1250%	01/13/03	2.2100%	01/13/03	\$10,000,000.00	\$10,081,773.17	2.4059%
FED HOME LOAN BANK	2.2500%	02/12/03	2.2500%	02/12/03	\$10,000,000.00	\$10,000,000.00	2.3864%
FED HOME LOAN MTG CORP	1.7000%	12/26/02	1.7000%	12/26/02	\$15,000,000.00	\$14,939,441.67	3.5652%
FEDERAL NATL MTG ASSOC	2.2000%	04/04/03	2.2000%	04/04/03	\$10,000,000.00	\$9,889,000.00	2.3599%
FEDERAL NATL MTG ASSOC	2.3000%	05/02/03	2.3000%	05/02/03	\$10,000,000.00	\$9,866,875.00	2.3547%
FNMA P-302.75	1.7220%	05/07/03	1.7225%	10/01/02	\$5,000,000.00	\$4,999,216.69	1.1930%
FNMA 1M L-14.25	1.6770%	10/04/02	1.6775%	10/04/02	\$10,000,000.00	\$9,999,974.39	2.3864%
FNMA FRN (PRIME-299.75 BP)	1.7520%	01/03/03	1.7525%	10/01/02	\$5,000,000.00	\$4,999,581.67	1.1931%
FNMA 1M L-12	1.6910%	11/29/02	1.6912%	10/29/02	\$20,000,000.00	\$19,999,250.96	4.7727%
FED HOME LOAN MTG CORP	2.1000%	10/10/03	2.1000%	10/10/03	\$5,000,000.00	\$5,000,000.00	1.1932%
FEDERAL NATL MTG ASSOC	2.0100%	09/05/03	2.0100%	09/05/03	\$15,000,000.00	\$15,000,000.00	3.5796%
OPIC GOVT GTD AGENCY	VARIABLE	04/02/07	1.7800%	10/06/02	\$2,800,000.00	\$2,800,326.58	0.6683%
OPIC GOVT GTD AGENCY	VARIABLE	04/02/07	1.7800%	10/06/02	\$7,200,000.00	\$7,279,707.89	1.7372%

**INVESTORS CASH TRUST - GOVERNMENT SECURITIES PORTFOLIO**  
**September 30, 2002**

CATEGORY OF HOLDINGS	ISSUE RATE	ISSUE DUE DATE	PURCHASE RATE	DUE DATE	PAR VALUE	BOOK VALUE	% OF TOTAL
SLMA FR (3M TB+22) @ + .20	1.8580%	02/12/04	1.8590%	10/01/02	\$10,000,000.00	\$9,995,927.94	2.3854%
US GOV GTD-TOTEM OCEAN	1.7390%	12/18/04	1.7400%	10/27/02	\$10,000,000.00	\$10,000,000.00	2.3864%
<b>TOTAL AGENCIES SECURITIES</b>					<b>\$228,500,000.00</b>	<b>\$228,486,896.72</b>	<b>54.5266%</b>

**REPURCHASE AGREEMENTS**

Bear Stearns & Co.							
TRP BEAR STEARNS GVT	1.9600%	10/01/02	1.9600%	10/01/02	\$20,000,000.00	\$20,000,000.00	4.7728%
First Boston Corp							
TRP FIRST BOSTON GVT	1.9600%	10/01/02	1.9600%	10/01/02	\$20,000,000.00	\$20,000,000.00	4.7728%
Goldman Sachs							
TRP GOLDMAN SACHS GVT	1.9400%	10/01/02	1.9400%	10/01/02	\$20,000,000.00	\$20,000,000.00	4.7728%
Greenwich Capital Markets							
TRP GREENWICH CAP GVT	1.9600%	10/01/02	1.9600%	10/01/02	\$20,000,000.00	\$20,000,000.00	4.7728%
J.P. Morgan Securities							
TRP JP MORGAN SECS	1.9600%	10/01/02	1.9600%	10/01/02	\$20,000,000.00	\$20,000,000.00	4.7728%
Lehman Brothers							
TRP LEHMAN BROS GVTs	1.8500%	10/01/02	1.8500%	10/01/02	\$25,000,000.00	\$25,000,000.00	5.9661%
Salomon Brothers							
TRP SALOMON BROS GVT	1.9600%	10/01/02	1.9600%	10/01/02	\$20,000,000.00	\$20,000,000.00	4.7728%

INVESTORS CASH TRUST - GOVERNMENT SECURITIES PORTFOLIO  
September 30, 2002

CATEGORY OF HOLDINGS	ISSUE RATE	ISSUE DUE DATE	PURCHASE RATE	DUE DATE	PAR VALUE	BOOK VALUE	% OF TOTAL
State Street Bank Repo							
SSB REPO	1.8300%	10/01/02	1.8300%	10/01/02	\$4,053,000.00	\$4,053,000.00	0.9672%
TOTAL REPURCHASE AGREEMENTS					\$149,053,000.00	\$149,053,000.00	35.5703%
TOTAL INVESTMENTS					\$417,553,000.00	\$417,512,074.50	99.6360%
Other Assets Less Liabilities						\$1,525,425.73	0.3640%
TOTAL NET ASSETS						\$419,037,500.23	
TOTAL NET ASSETS (TREASURY PORTFOLIO)						\$54,644,885.93	
TOTAL NET ASSETS (ICT)						\$473,682,386.16	

27

## BANK ACCT

FM ACCT

DATE

DAILY  
PURCHASE  
+DAILY  
RELEASE  
-

BAI Fwd	\$0.00	\$0.00
Sept 1-9	\$4,455.55	\$0.00
Sept 10-16	\$0.00	\$0.00
Sept 17-24	\$0.00	\$0.00
Sept 25-30	\$0.00	\$0.00

490202	490202	490202	490202	412430
6540001432	6540001432	6540001432	6540001432	6540001443
General	CLL	Hughes	Bates	93 CERT.I&S
01	10	14	22	24
\$2,771,023.69	\$57,272.81	\$465,529.71	\$80,196.39	\$102.45
\$2,771,023.69	\$57,272.81	\$465,529.71	\$80,196.39	\$102.45
\$2,771,023.69	\$57,272.81	\$465,529.71	\$80,196.39	\$102.45
\$2,771,023.69	\$57,272.81	\$465,529.71	\$80,196.39	\$102.45

412732	416320	422037	422258
6540001443	6540001443	6540001443	6540001443
94 CERT.I&S	95 I&S	98IS	98 TAX IS
39	54	99	101
\$2,902.75	\$2,243.79	\$12,790.86	\$57.57
\$2,902.75	\$2,243.79	\$12,790.86	\$57.57
\$2,902.75	\$2,243.79	\$12,790.86	\$57.57
\$2,902.75	\$2,243.79	\$12,790.86	\$57.57

**915-659-6440**

VOL. 75 PG. 518

22

*MBIA*  
*Danny King*

- 1) Collateral Statement
- 2) Treasurer Daily Balance
- 3) Interest Rates
- 4) Portfolio Participants

30



## *Notes*

### *September 2002*

For more information, call MBIA Client Services at (800)395-5505  
Fax: (800)765-7600

For the month of September 2002, MBIA Municipal Investors Service Corporation, in its role as Program Administrator, accrued fees of \$124,753 based on average assets for CLASS Texas of \$758,913,916. The fee is accrued on a daily basis by multiplying the value of the investment property as determined each day by the fee rate of 20 basis points (.0020) divided by 365 days. The monthly fee is the sum of all daily fee accruals for the month of September. The fee is paid monthly upon notification to the custodial bank. MBIA reserves the right to abate fees.

As a registered investment adviser, we are required to furnish you with a copy of our ADV Part II of the SEC registration form. If you would like a copy of this form, please contact us at 800-395-5505.

The following information is provided in accordance with Texas state statute 2256.0016. As of September 30, 2002 the portfolio contained the following:

Securities by type:

Commercial Paper - 70.17%, US Govt Sponsored - 23.12%, US Agency Discount Notes - 2.44%, Repurchase Agreements - 4.27%

The portfolio is marked to market at the end of each business day.

Current information can be provided to you by calling your Client Service Representative at 1-800-395-5505.

Market Value at 09/30/2002 - \$770,498,655.20

Amortized Cost at 09/30/2002 - \$770,227,756.48

Difference - \$270,898.72

The current LOC for the portfolio is \$5,000,000.

Net Asset Value as of 09/30/2002 is equal to 1.00

Dollar Weighted Average Maturity - 51 days

The final maturity dates of all securities were less than one year.

The custodial bank for Texas CLASS is Bank One, Texas.

The portfolio managers of MBIA Capital Management Corp - sub advisor for Texas CLASS are Eric Storch and Melissa Wright.

There were no changes to the Trust Agreement.



Security ID	Description	Quantity	Price	Amort. Cost	Market Value	Unrealized G/L	% Price Chg
Non U.S. Govt Bonds (LT)							
31331L4X3	Fed Farm Credit Bank Agency dtd 8/14/02 2.26% Due 8/14/2003 FA14	10,745,000.00	100.094	10,745,000.00	10,755,100.30	10,100.30	(0.03)
31331LJU3	Fed Farm Credit Bank Agency dtd 5/1/01 4 3/8% Due 5/1/2003 MN1	1,900,000.00	101.625	1,927,019.94	1,930,875.00	3,855.06	0.00
31331LYN2	Fed Farm Credit Bank Agency dtd 2/1/02 2.3% Due 2/3/2003 FA3	6,000,000.00	100.250	6,001,611.27	6,015,000.00	13,388.73	0.00
31331QCA3	FFCB Agency dtd 9/26/02 1.99% Due 9/26/2003 MS26	10,000,000.00	100.090	9,997,337.11	10,009,000.00	11,662.89	(0.03)
3133M2EY9	Federal Home Loan Bank Agency dtd 11/26/97 6.03% Due 11/26/2002 MN26	2,000,000.00	100.656	2,011,853.42	2,013,120.00	1,266.58	(0.02)
3133M2Q91	Federal Home Loan Bank Agency dtd 1/15/98 5.4% Due 1/15/2003 JJ15	9,655,000.00	101.094	9,749,593.09	9,760,625.70	11,032.61	0.00
3133MCUE3	Federal Home Loan Bank Agency 5 1/8% Due 1/13/2003 JJ13	10,000,000.00	101.000	10,078,916.23	10,100,000.00	21,083.77	0.00
3133MEUD1	Federal Home Loan Bk Bd 4 1/2% Due 5/15/2003 MN15	5,000,000.00	101.813	5,060,768.54	5,090,650.00	29,881.46	0.06
3133MMTW3	FHLB Agency dtd 3/28/02 2.83% Due 4/21/2003 AO21	5,000,000.00	100.719	5,021,357.36	5,035,950.00	14,592.64	0.09
3133MPKE5	FHLB Agency dtd 7/22/02 2.405% Due 7/22/2003 JJ22	10,000,000.00	100.031	10,000,000.00	10,003,100.00	3,100.00	0.03
3133MQFW9	FHLB Agency dtd 7/29/02 1 3/4% Due 7/29/2003 JJ29	7,000,000.00	100.156	7,001,012.86	7,010,920.00	9,907.14	0.03
3134A33D6	Fed Home Ln Mtg Agency 7% Due 2/15/2003 FA15	10,000,000.00	102.000	10,178,053.42	10,200,000.00	21,946.58	0.00
3134A3T48	Fed Home Ln Mtg Agency 6 1/4% Due 10/15/2002 AO15	5,600,000.00	100.180	5,608,713.29	5,610,080.00	1,366.71	(0.01)
3136F1GJ3	FNMA Agency 2 1/4% Due 1/28/2003 JJ28	2,000,000.00	100.219	2,000,104.05	2,004,380.00	4,275.95	(0.03)
86387SFX3	Student Loan Marketing Assn Agy dtd 4/25/02 2.7% Due 4/25/2003 AO25	5,000,000.00	100.640	4,998,635.51	5,032,000.00	33,364.49	0.01

22

QUOTED IN: United States Dollar

Security ID	Description	Quantity	Price	Amort. Cost	Market Value	Unrealized G/L	% Price Chg
TOTAL - Non U.S. Govt Bonds (LT)		99,900,000.00		100,379,976.09	100,570,801.00	190,824.91	
Bonds Taxable (ST)							
312925KY5	FHLMC FRN Adj % Due 5/15/2003 MN15	20,000,000.00	99.990	20,000,000.00	19,998,000.00	-2,000.00	(0.01)
313588BP9	Fedl Natl Mtge Assn Discount Notes Due 2/7/2003 At Mat	4,304,000.00	99.375	4,272,335.00	4,277,100.00	4,765.00	0.00
313588HK4	Fedl Natl Mtge Assn Discount Notes Due 6/27/2003 At Mat	15,000,000.00	98.875	14,771,387.97	14,831,250.00	59,862.03	0.00
86387SFY1	Student Loan Marketing Assn Agency dtd 4/25/02	50,000,000.00	99.990	50,000,000.00	49,995,000.00	-5,000.00	(0.01)
91226\$\$01	Adj % Due 4/25/2003 JAJ025 Greenwich Capital Repurchase Agreement 1.85% Due 10/1/2002 At Mat	33,328,000.00	100.000	33,328,000.00	33,328,000.00	0.00	0.00
TOTAL - Bonds Taxable (ST)		122,632,000.00		122,371,722.97	122,429,350.00	57,627.03	
Money Market Securities							
03218SK41	Amstel Funding Corp Commercial Paper 10/4/02 A1+ Due 10/4/2002 At Mat	25,000,000.00	99.985	24,996,081.16	24,996,250.00	168.84	0.00
03218SK74	Amstel Funding Corp Commercial Paper 10/7/02 A1+ Due 10/7/2002 At Mat	10,000,000.00	99.970	9,996,882.12	9,997,000.00	117.88	0.00
03218SL16	Amstel Funding Corp Commercial Paper 11/1/02 A1+ Due 11/1/2002 At Mat	12,000,000.00	99.851	11,979,478.25	11,982,120.00	2,641.75	0.00
03832MK81	Apreco Inc Commercial Paper 10/8/02 A1+ Due 10/8/2002 At Mat	20,000,000.00	99.965	19,993,226.13	19,993,000.00	-226.13	0.00
03832MKF5	Apreco Inc Commercial Paper 10/15/02 A1+ Due 10/15/2002 At Mat	10,000,000.00	99.932	9,993,112.26	9,993,200.00	87.74	0.00
04542MK72	Asset Securitization Coop Commercial Paper 10/7/02 A1+ Due 10/7/2002 At Mat	20,000,000.00	99.970	19,994,092.16	19,994,000.00	-92.16	0.00
04542ML63	Asset Securitization Coop Commercial Paper 11/6/02 A1+ Due 11/6/2002 At Mat	10,000,000.00	99.828	9,982,296.52	9,982,800.00	503.48	0.00

Texas CLASS

DAILY VALUATION REPORT  
09/30/2002  
QUOTED IN: United States Dollar

RUN DATE: 10/01/02  
RUN TIME: 12:43:32  
PAGE: 3

VOL. 75 PG. 522

33

Security ID	Description	Quantity	Price	Amort. Cost	Market Value	Unrealized G/L	% Price Chg
04915UM48	Atlantis One Funding Commercial Paper 12/4/02 A1+ Due 12/4/2002 At Mat	10,000,000.00	99.699	9,966,751.24	9,969,900.00	3,148.76	0.00
21987NLE0	Corporate Asset Funding Co. Commercial Paper 11/14/02 A1+ Due 11/14/2002 At Mat	30,000,000.00	99.789	29,935,814.61	29,936,700.00	885.39	0.00
27003LKA0	Eagle Funding Commercial Paper 10/10/02 A1 Due 10/10/2002 At Mat	14,767,000.00	99.955	14,760,239.29	14,760,354.85	115.56	0.00
27003LKH5	Eagle Funding Commercial Paper 10/17/02 A1 Due 10/17/2002 At Mat	10,579,000.00	99.919	10,570,346.07	10,570,431.01	84.94	0.00
30601WK16	Fairway Finance Corp. Commercial Paper 10/1/02 A1 Due 10/1/2002 At Mat	25,800,000.00	100.000	25,800,000.00	25,800,000.00	0.00	0.00
36959JK85	General Electric Capital Co Commercial Paper 10/8/02 A1+ Due 10/8/2002 At Mat	7,000,000.00	99.965	6,997,142.07	6,997,550.00	407.93	0.00
38142UN65	Goldman Sachs Commercial Paper 1/6/03 A1+ Due 1/6/2003 At Mat	15,000,000.00	99.552	14,926,165.44	14,932,800.00	6,634.56	0.00
3814A5AZ1	Goldman Sachs CP FLT Adj % Due 9/16/2003 Sched	20,000,000.00	100.000	20,000,000.00	20,000,000.00	0.00	0.00
38486UKJ4	Gramercy Capital Corp Commercial Paper 10/18/02 A1+ Due 10/18/2002 At Mat	27,862,000.00	99.907	27,838,690.24	27,836,088.34	-2,601.90	0.00
44977SL52	ING Insurance Commercial Paper 11/5/02 A1+ Due 11/5/2002 At Mat	10,000,000.00	99.832	9,983,525.36	9,983,200.00	-325.36	0.00
4497W1KX3	ING Funding Commercial Paper 10/31/02 A1+ Due 10/31/2002 At Mat	20,000,000.00	99.837	19,967,067.97	19,967,400.00	332.03	0.00
59018KND9	Merrill Lynch & Co. Inc. Commercial Paper 1/13/03 A1+ Due 1/13/2003 At Mat	10,000,000.00	99.520	9,949,723.61	9,952,000.00	2,276.39	0.00
59018KNQ0	Merrill Lynch & Co. Inc. Commercial Paper 1/24/03 A1+ Due 1/24/2003 At Mat	16,000,000.00	99.469	15,911,573.53	15,915,040.00	3,466.47	0.00
61745BK48	Morgan Stanley Dean Witter Commercial Paper 10/4/02 A1+ Due 10/4/2002 At Mat	35,000,000.00	99.985	34,994,834.45	34,994,750.00	-84.45	0.00
61911SMB1	MINT Commercial Paper 12/11/02 A1+ Due 12/11/2002 At Mat	15,000,000.00	99.625	14,948,163.65	14,943,750.00	-4,413.65	0.00

Texas CLASS

DAILY VALUATION REPORT  
09/30/2002  
QUOTED IN: United States Dollar

RUN DATE: 10/01/02  
RUN TIME: 12:43:32  
PAGE: 4

Security ID	Description	Quantity	Price	Amort. Cost	Market Value	Unrealized G/L	% Price Chg
64351QLJ0	New Center Asset Trust Commercial Paper 11/18/02 A1+ Due 11/18/2002 At Mat	20,000,000.00	99.772	19,951,749.10	19,954,400.00	2,650.90	0.00

VOL. 75 PG. 523

22

7403P1\$24	Preferred Rec Funding Commercial Paper 10/2/02 A1 Due 10/2/2002 At Mat	30,000,000.00	99.995	29,998,530.82	29,998,500.00	-30.82	0.00
7561V5K15	Receivables Capital Corp. Commercial Paper 10/1/02 A1+ Due 10/1/2002 At Mat	20,000,000.00	100.000	20,000,000.00	20,000,000.00	0.00	0.00
82124MK17	Sheffield Receivables Commercial Paper 10/1/02 A1+ Due 10/1/2002 At Mat	22,110,000.00	100.000	22,110,000.00	22,110,000.00	0.00	0.00
82656U\$C0	Sigma Finance Inc. Commercial Paper 11/12/02 A1+ Due 11/12/2002 At Mat	25,000,000.00	99.799	24,943,353.01	24,949,750.00	6,396.99	0.00
86888NK95	Surrey Funding Corp Commercial Paper 10/9/02 A1+ Due 10/9/2002 At Mat	32,000,000.00	99.961	31,987,218.36	31,987,520.00	301.64	0.00
90262D\$12	UBS Finance Delaware Inc. Commercial Paper 10/1/02 A1+ Due 10/1/2002 At Mat	25,000,000.00	100.000	25,000,000.00	25,000,000.00	0.00	0.00
TOTAL - Money Market Securities		548,118,000.00		547,476,057.42	547,498,504.20	22,446.78	
TOTAL - Texas CLASS		770,650,000.00		770,227,756.48	770,498,655.20	270,898.72	

## BANK ACCT

MBIA ACC'

DATE	DAILY PURCHASE +	DAILY RELEASE -
BAI Fwd	\$0.00	\$0.00
Sept 1-9	\$5,172.86	\$0.00
Sept 10-16	\$0.00	\$410,500.00
Sept 17-24	\$77,000.00	\$77,000.00
Sept 25-30	\$0.00	\$0.00

490202 TX010145-1 General (1)	490202 TX010145-1 F/M 1 & 3 (5)	490202 TX010145-1 F/M 2 & 4 (6)
\$1,963,025.38	\$330,267.52	\$604,318.09
\$1,603,025.38	\$305,267.52	\$579,318.09
\$1,680,025.38	\$280,267.52	\$534,318.09
\$1,400,025.38	\$255,267.52	\$509,318.09

		490202	490202	490202	490202	490202	490202
		TX010145-1	TX010145-1	TX010145-1	TX010145-1	TX010145-1	TX010145-1
		CLL	JCTF	Libr -Hughes	Libr-Donations	DC-RM	Co Crts-Sec
		(10)	(12)	(14)	(15)	(17)	(18)
Sub-Total	\$280,368.29	\$17,226.83	\$25,074.47	\$1,533.06	\$57,395.28	\$11,956.23	\$167,564.30
Sub-Total	\$280,775.15	\$17,251.81	\$25,074.47	\$1,533.06	\$57,395.28	\$11,956.23	\$167,564.30
Sub-Total	\$280,775.15	\$17,251.81	\$25,074.47	\$1,533.06	\$57,395.28	\$11,956.23	\$167,564.30
Sub-Total	\$280,775.15	\$17,251.81	\$25,074.47	\$1,533.06	\$57,395.28	\$11,956.23	\$167,564.30
Sub-Total	\$280,775.15	\$17,251.81	\$25,074.47	\$1,533.06	\$57,395.28	\$11,956.23	\$167,564.30

	490202	490202	490202	490202	490202	490202
	TX010145-1	TX010145-1	TX010145-1	TX010145-1	TX010145-1	TX010145-1
	CC-Rm	Libr Misc	Bates	GLP	CCPreserv	Motorist
	(19)	(20)	(22)	(25)	(30)	(31)
Sub-Total	\$86,742.17	\$10,719.92	\$42,155.16	\$3,221.68	\$9,975.80	\$13,876.35
Sub-Total	\$86,868.00	\$10,735.51	\$42,155.16	\$3,221.68	\$9,975.80	\$13,876.35
Sub-Total	\$86,868.00	\$10,735.51	\$42,155.16	\$3,221.68	\$9,975.80	\$13,876.35
Sub-Total	\$86,868.00	\$10,735.51	\$42,155.16	\$3,221.68	\$9,975.80	\$13,876.35
Sub-Total	\$86,868.00	\$10,735.51	\$42,155.16	\$3,221.68	\$9,975.80	\$13,876.35

		490202	490202	490202	490202	490202
		TX010145-1	TX010145-1	TX010145-1	TX010145-1	TX010145-1
		CVCA	OJP	Arrest	JE	SMF
		(60)	(61)	(68)	(70)	(71)
Sub-Total	\$38,023.73	\$13,132.02	\$3,319.90	\$2,146.55	\$1,361.88	\$18,068.19
Sub-Total	\$38,028.54	\$13,132.02	\$3,319.90	\$2,146.55	\$1,361.88	\$18,068.19
Sub-Total	\$38,028.54	\$13,132.02	\$3,319.90	\$2,146.55	\$1,361.88	\$18,068.19
Sub-Total	\$38,028.54	\$13,132.02	\$3,319.90	\$2,146.55	\$1,361.88	\$18,068.19
Sub-Total	\$38,028.54	\$13,132.02	\$3,319.90	\$2,146.55	\$1,361.88	\$18,068.19

	490202	490202	490202	490202	490202	490202
	TX010145-1	TX010145-1	TX010145-1	TX010145-1	TX010145-1	TX010145-1
	CCC	Time	Fugitive	Indigent	Sheriff	Court Trans.
	(72)	(74)	(77)	(78)	(97)	(106)
Sub-Total	\$57,348.24	\$15,906.09	\$2,483.86	\$3,555.02	\$220.48	\$9,975.74
Sub-Total	\$57,399.25	\$15,906.09	\$2,483.86	\$3,555.02	\$220.48	\$9,975.74
Sub-Total	\$57,399.25	\$15,906.09	\$2,483.86	\$3,555.02	\$220.48	\$9,975.74
Sub-Total	\$50,399.25	\$15,906.09	\$2,483.86	\$3,555.02	\$220.48	\$9,975.74
Sub-Total	\$50,399.25	\$15,906.09	\$2,483.86	\$3,555.02	\$220.48	\$9,975.74

Prepared by Melissa Wright, Portfolio Manager  
MBIA Capital Management Corp.

## MARKET COMMENTARY – TREASURY YIELDS HIT FORTY-YEAR LOWS

As the likelihood of another interest rate cut by the Federal Open Market Committee (FOMC) escalated, treasury yields plummeted to yields not seen since the early 1960's. It was just over a year ago that yields on three-month treasury bills were yielding 4%. Now, investing in a ten-year treasury note yields just 3.8% (during the fourth week of September, the yield on 10 year treasuries fell as low as 3.65%.) Factors that contributed to the flight to quality in September included fear of an impending war on Iraq, a sluggish economy, falling consumer confidence and the continued sell-off in the stock market. If the economy continues to show signs of weakness, the Fed may move to lower interest rates at their next meeting, scheduled for November 6th.

Economic statistics released over the past few weeks have shown few signs of relief on the horizon. Although there have been glimmers of good news--such as strength in consumer spending and the housing market--there is a prevailing gray cloud that has been hovering over the economy for most of the year. We are in the midst of a profitless recovery and until corporations can show renewed signs of strength, we are likely to move sideways for a while. The FOMC is likely to keep interest rates accommodative until well into next year. At the most recent FOMC meeting on September 24th, two of the policy-committee members dissented the decision to keep interest rates unchanged. This unusual disagreement proves there is ample concern over the direction of the economy and reinforces the possibility of a rate cut in the months ahead.

The FOMC will meet again on November 6th, 2002. Economic statistics to watch in October are: ISM (formerly NAPM – 10/1), the employment situation (10/4), Producer Price Index (10/11), Retail Sales (10/11), Industrial Production (10/17), Housing Starts (10/17), Consumer Price Index (10/18), Durable Goods Orders (10/25) and Gross Domestic Product (10/31).

As of September 27, 2002, the Dow was down approximately 11.1% for the month (down 23% year-to-date), the NASDAQ was down 8.8% (down 38% year to date) and the S&P500 was down 9.7% for the month (down 27.9% year-to-date.)

## SECTOR REVIEW

**U.S. Treasuries:** Treasuries rallied again in September, with yields hitting 40-year lows. Most notably, yields on 10-year securities dropped to a 3.62%, as stocks deteriorated. The short end of the curve remains inverted with three-month bills yielding 1.62% and 6-month bills yielding a 1.55%. Fed Fund futures are currently pricing in a 70% chance of a 25 basis point rate cut at the next FOMC meeting.

In our Treasury portfolios, we are keeping our weighted average maturities (WAM) in the low-50 range. If economic statistics continue to deteriorate, we may seek to lengthen the WAM ahead of any rate cut. As yields pick up in the long end of the curve, we will look to barbell the portfolios in order to capture any additional yield. At the end of September, 2-year treasuries were yielding 1.77%, 10-year treasuries were yielding 3.62% and 30-year bonds were yielding 4.64%.

**Repurchase Agreements:** Overnight repurchase agreements (repo) started the month trading at 1.83%, dropped to a low of 1.67% mid-month and climbed up to 1.85% at month-end. Overnight repo has been averaging 1.75% for the past few months and we expect that to continue unless the Fed eases rates in the months ahead.

**Commercial Paper:** Sixty-day commercial paper (CP) averaged a 1.73% for the month of September. As we neared the end of the quarter we saw overnight CP rates spike up to the 1.80% level. The Fed Funds rate currently stands at 1.75% but the bias is towards weakness, this means we could see the FOMC lower interest rates if warranted. With this in mind, we are keeping the WAM in our commercial paper portfolios in the mid to high 50's in order to lock in yield.

**U.S. Government Agencies:** At the end of September, discount notes were trading around a 1.70% for one-month securities and 1.65% for six-month and one year securities. We expect agency issuance to increase in the coming months which should push rates up on a relative basis.

In our agency portfolios we are keeping the WAM in the low-to-mid-50 range and we will look to extend if economic statistics deteriorate further.

**Note:** This review covers a variety of instruments—all MBIA programs invest only in investments permitted by statute or program guidelines. The opinions expressed above are those of MBIA Asset Management and are subject to change without notice.

Client Services  
1-800-395-5505

MBIA Municipal Investors  
Service Corporation  
113 King Street  
Armonk, NY 10504

Visit our web site:  
[www.MBIA.com](http://www.MBIA.com)

**MBIA**

37



## *Texas CLASS Daily Rates September 2002*

For more information, call MBIA Client Services at (800)395-5505  
Fax: (800)765-7600



<i>Date</i>	<i>Daily Rates</i>	<i>Annual Yield</i>
09/01/02	1.70%	1.72%
09/02/02	1.70%	1.72%
09/03/02	1.71%	1.72%
09/04/02	1.70%	1.71%
09/05/02	1.70%	1.71%
09/06/02	1.69%	1.71%
09/07/02	1.69%	1.71%
09/08/02	1.69%	1.71%
09/09/02	1.70%	1.71%
09/10/02	1.70%	1.71%
09/11/02	1.69%	1.70%
09/12/02	1.69%	1.70%
09/13/02	1.68%	1.69%
09/14/02	1.68%	1.69%
09/15/02	1.68%	1.69%
09/16/02	1.70%	1.71%
09/17/02	1.69%	1.70%
09/18/02	1.69%	1.70%
09/19/02	1.69%	1.70%
09/20/02	1.69%	1.70%
09/21/02	1.69%	1.70%
09/22/02	1.69%	1.70%
09/23/02	1.70%	1.71%
09/24/02	1.70%	1.71%
09/25/02	1.70%	1.71%
09/26/02	1.71%	1.72%
09/27/02	1.71%	1.72%
09/28/02	1.71%	1.72%
09/29/02	1.71%	1.72%
09/30/02	1.72%	1.73%
Average	1.70%	1.71%

Rates can vary over time. Past performance is no guarantee of future results.

September 2002

Page: 5

38

VOL. 75 PG. 527



## *Portfolio Participants September 2002*

For more information, call MBIA Client Services at (800)395-5505  
Fax: (800)765-7600

Alamo Heights ISD  
Angleton Independent School  
Atlanta ISD  
Bastrop County  
Bexar County Tax Assesor Collector  
City of Brownsville  
City of Bulverde  
Calhoun County ISD  
Carroll ISD  
Central Texas College  
Cherokee County  
City of Jacksonville  
Coastal Bend College  
Collin County  
Columbus ISD  
City of Commerce  
Corpus Christi ISD  
Rockwall County  
City of DeSoto  
Del Valle ISD  
Dickinson ISD  
East Central ISD  
City of El Campo  
City of Elgin-Economic Development Corp.  
Town of Fairview  
City of Floresville  
Fort Bend County  
Franklin County  
Frenship ISD  
Guadalupe Blanco River Authority  
Goliad ISD  
Groesbeck ISD

Alice ISD  
Aransas County ISD  
City of Austin  
Beckville ISD  
City of Boerne  
Brownsville ISD  
Bulverde Area Rural Library District  
Canutillo ISD  
City of Castle Hills  
Channelview ISD  
City of Burleson  
City of Taylor  
Coastal Plains MHMR  
Colorado County  
City of Columbus  
City of Converse Econ. Dev. Cop.  
County of Bell  
Cypress Forest P.U.D.  
DeSoto ISD  
Denton County District Clerk  
Duncanville ISD  
East Texas Schools CO-OP ISD  
El Paso County 911 District  
Ellis County  
Farmersville ISD  
Fort Bend County M.U.D. 23  
Fort Bend County M.U.D. #25  
Frankston I.S.D.  
City of Friendswood  
Georgetown ISD  
Grand Prairie ISD  
Guadalupe County

Alvin ISD  
Arlington ISD  
Bandera ISD  
City of Bedford  
Brenham ISD  
City of Buda  
Caldwell ISD  
Canyon Lake Library District  
City of Cedar Hill  
Chelford One MUD  
City of Garland  
Clear Creek ISD  
Coke County  
Columbia - Brazoria ISD  
Comal ISD  
Coppell ISD  
Denton County  
Dallas ISD  
DeWitt Medical District  
Devers ISD  
Eanes ISD  
Ector County  
El Paso ISD  
Everman ISD  
First Colony Levy I.D.  
Fort Bend Cnty. M.U.D. # 2  
Fort Sam Houston ISD  
Fredericksburg ISD  
Friendswood ISD  
City of Goliad  
City of Greenville  
City of Haltom City





For more information, call MBIA Client Services at (800)395-5505  
Fax: (800)765-7600

Harris County Utility District #6  
Harris County MUD #153  
Harris County MUD #81  
Harris County Utility District #15  
City of Highland Village  
Howard County  
Irving ISD  
Kaufman I.S.D.  
Kilgore ISD  
La Vernia ISD  
Lamar County  
Laredo ISD  
Lee County  
Limestone County  
Lockhart ISD  
Marshall ISD  
City of Mercedes  
Midway ISD  
Montgomery County Mud #18  
Montgomery Cnty. M.U.D. # 7  
Montgomery Cnty. M.U.D. # 46  
Montgomery Cnty. M.U.D. # 67  
New Summerfield ISD  
City of North Richland Hills  
Northwest Harris County MUD #22  
Overton ISD  
City of Pasadena  
Pflugerville ISD  
Queen City ISD  
Red Oak I.S.D.  
Region 19 ESC  
Reid Road M.U.D. # 2  
Rio Grande City CISD  
Roma ISD  
Sabine ISD  
San Angelo ISD  
San Patricio Cnty. Drain Dist. (U.D.)

Harris Co. R.F.P.D #48  
Harris Co. MUD #151  
Harris Co. M.U.D. #148  
Hays CISD  
Hitchcock ISD  
Hurst, Euless, Bedford ISD  
Jacksonville ISD  
Kemp ISD  
Killeen ISD  
Lake Dallas ISD  
City of Lancaster  
City of Leander  
City of Levelland  
Little Elm ISD  
Mabank ISD  
City of McKinney  
Mercedes ISD  
Mission Bend M.U.D. #2  
Montgomery Cnty MUD # 39  
Montgomery Cnty. M.U.D. # 36  
Montgomery Cnty. M.U.D. # 47  
Navarro County  
North East ISD  
Northside ISD  
Northwest Harris Co. MUD #16  
Palestine ISD  
Pecan Grove M.U.D.  
Pharr-San Juan-Alamo ISD  
Randolph Field ISD  
Redwater ISD  
Region II ESC  
Rice CISD  
Rockett Special Utility District (SUD)  
Roosevelt ISD  
Salado ISD  
San Felipe Del Rio Public Facility Corp  
San Patricio County

Harris County MUD #102  
Harris Co. Municipal Util. District #46  
Harris County Utility District #14  
Hays County  
Hopkins County  
Industrial ISD  
Johnson County  
Kenedy ISD  
City of Kingsville  
Lamar CISD  
City of Laredo  
Leander ISD  
City of Levelland Economic Dev Corp  
City of Lockhart  
Magnolia ISD  
McKinney ISD  
Meyersville ISD  
Mission CISD  
Montgomery Cnty. M.U.D. # 6  
Montgomery Cnty. M.U.D. # 40  
Montgomery Cnty. M.U.D. # 60  
New Braunfels ISD  
North Forest ISD  
Northwest Harris County M.U.D. #21  
Nueces County Hospital District  
Palmer ISD  
Pettus ISD  
Pine Tree I.S.D.  
Raymondville ISD  
Refugio ISD  
Region One ESC  
Richardson ISD  
Rockwall ISD  
City of Rosenberg  
Salado Public Library District  
San Felipe - Del Rio CISD  
Santa Fe ISD



For more information, call MBIA Client Services at (800)395-5505  
Fax: (800)765-7600

City of Schertz  
Scurry - Rosser ISD  
City of Sherman  
City of South Houston  
Tatum ISD  
Temple ISD  
Texarkana ISD  
Texas School for the Deaf  
Tom Green County Clerk  
Troup ISD  
Van Zandt County  
Waco ISD  
Washington County  
Weslaco ISD  
White Oak ISD  
Willacy County  
Wylie ISD  
Celina ISD

Schertz/Seguin Local Gov't Corp.  
Seguin ISD  
Sherman I.S.D.  
Spencer Road Public Utility District  
Taylor ISD  
Temple College  
Texas School for the Blind ISD  
The Woodlands Joint Powers Agency  
Tom Green County  
Tuloso - Midway ISD  
Victoria ISD  
Waller County  
Waxahachie I.S.D.  
West Harris County Mud #11  
City of Whitehouse  
Willow Fork Drainage District (U.D.)  
Yorktown ISD

Schertz - Cibolo Universal City ISD  
City of Shavano Park  
Sinton ISD  
Tarrant County  
City of Temple  
Terrell ISD  
Texas CLASS  
The Woodlands M.U.D. # 2  
Tropical Texas MHMR  
United ISD  
Village of Bee Cave  
Waller ISD  
Webb County  
City of White Oak  
Whitesboro I.S.D.  
City of Woodcreek  
Ysleta ISD

## *Tom Green County Indebtedness*

- 1) Debt Balances Per TGC
- 2) Debt Balances Per Rausher

42

Indebtedness

		September-02		
		TOM GREEN COUNTY INDEBTEDNESS Principal Payments Due Every February		
Fund Name	Fund Title	ORIGINAL	Previous O/S Balance	Current O/S Balance
FUND 23	TGC '92 CERTIFICATE OBLIGATION	(\$9,000,000.00)	(\$400,000.00)	\$0.00
FUND 28	TGC '93-A CERTIFICATE OBLIGATION	(\$790,000.00)	(\$15,000.00)	\$0.00
FUND 44	TGC '94 GENERAL REFUNDING BOND	(\$3,840,000.00)	(\$695,000.00)	\$0.00
	** NOTE THESE ISSUES ARE PAID OFF ON 02/01/02 **			\$0.00
FUND 24	TGC '93 CERTIFICATE OBLIGATION	(\$1,500,000.00)	(\$150,000.00)	(\$75,000.00)
FUND 54	TGC '95 CERT. OBLIG CONSTRUCTION	(\$8,000,000.00)	(\$300,000.00)	(\$275,000.00)
	** NOTE THESE ISSUES MATURES ON 02/01/03 **			(\$350,000.00)
FUND 39	TGC '94 CONSTRUCTION	(\$2,600,000.00)	(\$475,000.00)	(\$365,000.00)
FUND 101	TGC TAX ANTICIPATION NOTES	(\$475,000.00)	(\$330,000.00)	(\$255,000.00)
	** NOTE THESE ISSUES MATURES ON 02/01/05 **			(\$620,000.00)
FUND 99	TGC '98 GNOB	(\$18,885,000.00)	(\$18,885,000.00)	(\$18,765,000.00)
	** NOTE THIS ISSUE MATURES ON 02/01/14 **			(\$18,765,000.00)
	TOTAL	(\$45,090,000.00)	(\$21,250,000.00)	(\$19,735,000.00)

VOL. 75 PG. 532

43

Prepared by TGC Treasurer

**Tom Green County  
Outstanding General Obligation Debt**

**Annual Total Debt Service Schedule (8 issues)**

	<u>FYE</u>	<u>Principal</u>	<u>Interest</u>	<u>Debt Service</u>	
	1999	\$1,145,000.00	\$1,028,576.05 *	\$2,173,576.05	
	2000	1,255,000.00	1,040,598.75	2,295,598.75	
	2001	1,325,000.00	977,277.50	2,302,277.50	
8 issues	2002	1,515,000.00	907,703.75	2,422,703.75	pay 3 issues final
5 issues	2003	1,640,000.00	835,526.25	2,475,526.25	pay 2 issues final
3 issues	2004	1,700,000.00	764,728.75	2,464,728.75	
3 issues	2005	1,785,000.00	691,578.75	2,476,578.75	pay 2 issues final
2 issue	2006	1,760,000.00	616,500.00	2,376,500.00	
	2007	1,845,000.00	539,432.50	2,384,432.50	
	2008	1,925,000.00	457,415.00	2,382,415.00	
	2009	2,005,000.00	370,955.00	2,375,955.00	
	2010	2,090,000.00	279,820.00	2,369,820.00	
	2011	2,190,000.00	182,425.00	2,372,425.00	
	2012	2,265,000.00	78,827.50	2,343,827.50	
	2013	320,000.00	17,840.00	337,840.00	
	2014	210,000.00	5,040.00	215,040.00	pay 100% issue final
	<b>Total</b>	<b>\$24,975,000.00</b>	<b>\$8,794,244.80</b>	<b>\$33,769,244.80</b>	

\* Includes accrued interest of \$65,954.19.

Tom G 39300

Tom Green County  
Outstanding General Obligation Debt  
Certificates of Obligation, Series 1993

Date	Principal	Coupon	Interest	Debt Service	FYE 9/30
					Debt Service
2/1/99	\$50,000.00	4.800%	\$8,287.50	\$58,287.50	
8/1/99			7,087.50	7,087.50	\$65,375.00
2/1/00	50,000.00	4.950%	7,087.50 ✓	57,087.50 ✓	
8/1/00			5,850.00	5,850.00 ✓	62,937.50
2/1/01	75,000.00	5.100%	5,850.00	80,850.00 ✓	
8/1/01			3,937.50	3,937.50 ✓	84,787.50
2/1/02	75,000.00	5.200%	3,937.50	78,937.50	
8/1/02			1,987.50	1,987.50	80,925.00
2/1/03	75,000.00	5.300%	1,987.50	76,987.50	76,987.50
Total	\$325,000.00		\$46,012.50	\$371,012.50	\$371,012.50

412430 93IS

024-230-444 bank  
G10 Pm  
G50 Int  
G75 out-lets

Final Pay Feb 2003

Tom639400

Tom Green County  
Outstanding General Obligation Debt  
Certificates of Obligation, Series 1994

Date	Principal	Coupon	Interest	Debt Service	FYE 9/30
					Debt Service
2/1/99	\$100,000.00	4.200%	\$18,685.00	\$118,685.00	
8/1/99			16,585.00	16,585.00	\$135,270.00
2/1/00	100,000.00	4.400%	16,585.00 ✓	116,585.00 ✓	
8/1/00			14,385.00	14,385.00	130,970.00
2/1/01	105,000.00	4.700%	14,385.00	119,385.00 ✓	
8/1/01			11,917.50	11,917.50	131,302.50
2/1/02	110,000.00	4.850%	11,917.50	121,917.50	
8/1/02			9,250.00	9,250.00	131,167.50
2/1/03	115,000.00	5.000%	9,250.00	124,250.00	
8/1/03			6,375.00	6,375.00	130,625.00
2/1/04	120,000.00	5.100%	6,375.00	126,375.00	
8/1/04			3,315.00	3,315.00	129,690.00
2/1/05	130,000.00	5.100%	3,315.00	133,315.00	133,315.00
Total	\$780,000.00		\$142,340.00	\$922,340.00	\$922,340.00

412132 9-17-05

39

C39-239-444 Frank

(610 P

(650 I

(675 suc

Final Pay Feb 2005

Tom Green

Tom Green County  
Outstanding General Obligation Debt  
Certificates of Obligation, Series 1995

<u>Date</u>	<u>Principal</u>	<u>Coupon</u>	<u>Interest</u>	<u>Debt Service</u>	<u>FYE 9/30</u>
					<u>Debt Service</u>
2/1/99	\$25,000.00	4.600%	\$9,337.50	\$34,337.50	
8/1/99			8,762.50	8,762.50	\$43,100.00
2/1/00	25,000.00	4.750%	8,762.50✓	33,762.50✓	
8/1/00			8,168.75	8,168.75 ✓	41,931.25
2/1/01	25,000.00	4.850%	8,168.75	33,168.75✓	
8/1/01			7,562.50	7,562.50✓	40,731.25
2/1/02	25,000.00	4.950%	7,562.50	32,562.50	
8/1/02			6,943.75	6,943.75	39,506.25
2/1/03	<u>275,000.00</u>	5.050%	<u>6,943.75</u>	<u>281,943.75</u>	<u>281,943.75</u>
Total	<u>\$375,000.00</u>		<u>\$72,212.50</u>	<u>\$447,212.50</u>	<u>\$447,212.50</u>

4/10/00

0535

054-278-440

Book

610

F

050

I

075

Sec

Final Pay  
Feb 2003



Tom Green County

Tom Green County  
Outstanding General Obligation Debt

GO Refunding Bonds, Series 1998

Date	Principal	Coupon	Interest	Debt Service	FYE 9/30
					Debt Service
2/1/99			\$345,309.38 *	\$345,309.38	
8/1/99			414,371.25	414,371.25	\$759,680.63
2/1/00			414,371.25	414,371.25 ✓	
8/1/00			414,371.25	414,371.25	828,742.50
2/1/01			414,371.25	414,371.25 ✓	
8/1/01			414,371.25	414,371.25	828,742.50
2/1/02	\$120,000.00	4.000%	414,371.25	534,371.25 ✓	
8/1/02			411,971.25	411,971.25	946,342.50
2/1/03	1,095,000.00	4.000%	411,971.25	1,506,971.25	
8/1/03			390,071.25	390,071.25	1,397,042.50
2/1/04	1,495,000.00	4.100%	390,071.25	1,885,071.25	
8/1/04			359,423.75	359,423.75	2,244,495.00
2/1/05	1,565,000.00	4.150%	359,423.75	1,924,423.75	
8/1/05			326,950.00	326,950.00	2,251,373.75
2/1/06	1,760,000.00	4.250%	326,950.00	2,086,950.00	
8/1/06			289,550.00	289,550.00	2,376,500.00
2/1/07	1,845,000.00	4.300%	289,550.00	2,134,550.00	
8/1/07			249,382.50	249,382.50	2,384,432.50
2/1/08	1,925,000.00	4.400%	249,382.50	2,174,882.50	
8/1/08			207,532.50	207,532.50	2,382,415.00
2/1/09	2,005,000.00	4.400%	207,532.50	2,212,532.50	
8/1/09			163,422.50	163,422.50	2,375,955.00
2/1/10	2,090,000.00	4.500%	163,422.50	2,253,422.50	
8/1/10			116,397.50	116,397.50	2,369,820.00
2/1/11	2,190,000.00	4.600%	116,397.50	2,306,397.50	
8/1/11			66,027.50	66,027.50	2,372,425.00
2/1/12	2,265,000.00	4.700%	66,027.50	2,331,027.50	
8/1/12			12,300.00	12,300.00	2,343,827.50
2/1/13	320,000.00	4.850%	12,300.00	332,300.00	
8/1/13			5,040.00	5,040.00	337,340.00
2/1/14	<u>210,000.00</u>	4.800%	<u>5,040.00</u>	<u>215,040.00</u>	<u>215,040.00</u>
Total	<u>\$18,385,000.00</u>		<u>\$8,029,674.38</u>	<u>\$26,914,674.38</u>	<u>\$26,914,674.38</u>

\* Includes accrued interest of \$64,457.75.

Final Pay  
Feb 2014

CRS 422057  
C99-307 444  
CIC  
CSC  
CIT  
F  
I  
Jue  
48

Tom Green

Tom Green County  
Outstanding General Obligation Debt

Tax Notes, Series 1998

Date	Principal	Coupon	Interest	FYE 9/30	
				Debt Service	Debt Service
2/1/99			\$8,016.67 *	\$8,016.67	
8/1/99			9,620.00	9,620.00	\$17,636.67
2/1/00	\$70,000.00	3.900%	9,620.00 ✓	79,620.00 ✓	
8/1/00			8,255.00	8,255.00	87,875.00
2/1/01	75,000.00	3.950%	8,255.00	83,255.00 ✓	
8/1/01			6,773.75	6,773.75	90,028.75
2/1/02	75,000.00	4.000%	6,773.75	81,773.75	
8/1/02			5,273.75	5,273.75	87,047.50
2/1/03	80,000.00	4.050%	5,273.75	85,273.75	
8/1/03			3,653.75	3,653.75	88,927.50
2/1/04	85,000.00	4.150%	3,653.75	88,653.75	
8/1/04			1,890.00	1,890.00	90,543.75
2/1/05	90,000.00	4.200%	1,890.00	91,890.00	91,890.00
Total	\$475,000.00		\$78,949.17	\$553,949.17	\$553,949.17

\* Includes accrued interest of \$1,496.44.

ASTANIS

101 422258

101-246-444 Bank

610

650

675

P

I

Sic

Final Pay  
Feb 2005

## *Tom Green County Interest*

- 1) Interest Earned Monthly
- 2) Interest Earned FY 2002
- 3) Interest Rates

50

# Interest Balances and Rates FY02

As of 09/09/02

	Budgeted	Received	Remaining (extra)
Depository Interest [-3701	\$74,461.00	\$84,757.03	(\$10,296.03)
Security Interest [-3704	\$47,500.00	\$62,528.84	(\$15,028.84)
MBIA [-3705	\$141,970.00	\$86,757.49	\$55,212.51
Funds Management [-3706	\$45,134.00	\$62,163.47	(\$17,029.47)
	<u>\$309,065.00</u>	<u>\$296,206.83</u>	<u>\$12,858.17</u>
			\$12,858.17

Remaining Revenue Budgeted but not collected

\$12,858.17

	<u>Previous Month</u>	<u>Current Month</u>
Geno Checking Interest Annual Yield	3.810%	3.820%
MBIA Annual Yield	1.710%	1.710%
Funds Management Compound Effective Yield	1.612%	1.620%

51

To: Dianna Spieker  
From: Joan Alexander

915-659-6440

<i>INVESTORS CASH TRUST ACCOUNTS</i>		<i>October 1, 2002 09/30/02 PM Posting</i>		
<i>ACCOUNT NAME</i>	<i>ACCOUNT #</i>	<i>INTEREST</i>	<i>BALANCE</i>	<i>TOTAL</i>
TOM GREEN COUNTY - GENERAL ACCOUNT	654-0001432	\$4,605.69	\$3,374,022.60	\$3,378,628.29
TOM GREEN COUNTY - DEBT SERVICE	654-0001443	\$24.72	\$18,097.42	\$18,122.14
AVERAGE RATE (08/31/02 THROUGH 09/30/02-31 days): 1.61%				
COMPOUND EFFECTIVE YIELD: 1.62%				
<i>TOTAL:</i>		<i>\$4,630.41</i>	<i>\$3,392,120.02</i>	<i>\$3,396,750.43</i>



## Summary Statement September 2002

For more information, call MBIA Client Services at (800)395-5505  
Fax: (800)765-7600

# CLASS

Tom Green County

Account Number: TX-01-0145-0001

Account Name: GENERAL OPERATIONAL

	Beginning Balance	Investments	Disbursements	Income Earned	Average Daily Balance	Month End Balance
This Month	\$3,360,681.93	\$0.00	\$410,500.00	\$4,343.08	\$3,116,692.42	\$2,954,525.01
Fiscal YTD						
Ending 09/30/02	\$2,714,131.24	\$5,882,447.00	\$5,713,185.00	\$71,131.77	\$3,846,265.57	\$2,954,525.01

Account Number: TX-01-0145-0002

Account Name: 95 CONSTRUCTION

	Beginning Balance	Investments	Disbursements	Income Earned	Average Daily Balance	Month End Balance
This Month	\$0.00	\$0.00	\$0.00	\$0.00	\$0.00	\$0.00
Fiscal YTD						
Ending 09/30/02	\$1,949,463.35	\$0.00	\$1,969,432.15	\$19,968.80	\$954,770.36	\$0.00

### Total of all accounts

	Beginning Balance	Investments	Disbursements	Income Earned	Average Daily Balance	Month End Balance
This Month	\$3,360,681.93	\$0.00	\$410,500.00	\$4,343.08	\$3,116,692.42	\$2,954,525.01
Fiscal YTD						
Ending 09/30/02	\$4,663,594.59	\$5,882,447.00	\$7,682,617.15	\$91,100.57	\$4,801,035.93	\$2,954,525.01

## -- Budget Inquiry - 2001-2002 Fiscal Year --

Revenue Account ID Mask(s): [-3701; [-3704; [-3705; [-3706

##.	Acct ID.....	Current Budget	YTD Revenue...	Revenue Receivable
1	001-370-3701	12,500.00	38,683.28	-26,183.28
2	001-370-3704	47,500.00	62,528.84	-15,028.84
3	001-370-3705	60,000.00	43,949.71	16,050.29
4	001-370-3706	7,500.00	38,182.52	-30,682.52
5	004-370-3701	0.00	0.00	0.00
6	005-370-3701	1,500.00	3,858.78	-2,358.78
7	005-370-3705	24,000.00	7,007.27	16,992.73
8	006-370-3701	1,500.00	3,176.28	-1,676.28
9	006-370-3705	24,000.00	9,217.32	14,782.68
10	007-370-3701	0.00	0.00	0.00
11	008-370-3701	0.00	1,167.53	-1,167.53
12	009-370-3701	150.00	-15.71	165.71
13	010-370-3701	200.00	134.29	65.71
		<hr/>	<hr/>	<hr/>
** 1 of 13 **		309,065.00	296,206.83	12,858.17

Enter 'N' for Next Screen, 'P' for Previous Screen, "Account Index" for  
Detailed Budget Inquiry, or 'X' to Exit: \_\_\_\_\_

---

54

-- Budget Inquiry - 2001-2002 Fiscal Year --

Revenue Account ID Mask(s): [-3701

##.	Acct ID.....	Current Budget	YTD Revenue...	Revenue Receivable
1	001-370-3701	12,500.00	38,683.28	-26,183.28
2	004-370-3701	0.00	0.00	0.00
3	005-370-3701	1,500.00	3,858.78	-2,358.78
4	006-370-3701	1,500.00	3,176.28	-1,676.28
5	007-370-3701	0.00	0.00	0.00
6	008-370-3701	0.00	1,167.53	-1,167.53
7	009-370-3701	150.00	-15.71	165.71
8	010-370-3701	200.00	134.29	65.71
9	012-370-3701	200.00	387.22	-187.22
10	014-370-3701	130.00	248.69	-118.69
11	015-370-3701	200.00	483.25	-283.25
12	017-370-3701	50.00	109.35	-59.35
13	018-370-3701	600.00	226.87	373.13
** 1 of 10 **		74,461.00	84,757.03	-10,296.03

Enter 'N' for Next Screen, 'P' for Previous Screen, "Account Index" for Detailed Budget Inquiry, or 'X' to Exit: \_\_\_\_\_

55



## -- Budget Inquiry - 2001-2002 Fiscal Year --

Revenue Account ID Mask(s): [-3704]

##.	Acct ID.....	Current Budget	YTD Revenue...	Revenue Receivable
1	001-370-3704	47,500.00	62,528.84	-15,028.84
2	053-370-3704	0.00	0.00	0.00
		<hr/>	<hr/>	<hr/>
** 1 of 1 **		47,500.00	62,528.84	-15,028.84

Enter "Account Index" for Detailed Budget Inquiry or 'X' to Exit: \_\_\_\_\_

34

-- Budget Inquiry - 2001-2002 Fiscal Year --

Revenue Account ID Mask(s): [-3705

##.	Acct ID.....	Current Budget	YTD Revenue...	Revenue Receivable
1	001-370-3705	60,000.00	43,949.71	16,050.29
2	005-370-3705	24,000.00	7,007.27	16,992.73
3	006-370-3705	24,000.00	9,217.32	14,782.68
4	010-370-3705	900.00	354.14	545.86
5	012-370-3705	0.00	74.47	-74.47
6	014-370-3705	70.00	12.61	57.39
7	015-370-3705	300.00	354.05	-54.05
8	017-370-3705	350.00	221.86	128.14
9	018-370-3705	6,000.00	3,185.34	2,814.66
10	019-370-3705	400.00	204.34	195.66
11	020-370-3705	700.00	741.06	-41.06
12	022-370-3705	20.00	20.71	-0.71
13	025-370-3705	350.00	180.24	169.76
		141,970.00	86,757.49	55,212.51

\*\* 1 of 3 \*\*

Enter 'N' for Next Screen, 'P' for Previous Screen, "Account Index" for Detailed Budget Inquiry, or 'X' to Exit: \_\_\_\_\_

57

## -- Budget Inquiry - 2001-2002 Fiscal Year --

Revenue Account ID Mask(s): [-3706

##.	Acct ID.....	Current Budget	YTD Revenue...	Revenue Receivable
1	001-370-3706	7,500.00	38,182.52	-30,682.52
2	010-370-3706	1,900.00	959.01	940.99
3	014-370-3706	10,600.00	8,129.95	2,470.05
4	022-370-3706	3,450.00	1,384.03	2,065.97
5	023-370-3706	1,600.00	307.32	1,292.68
6	024-370-3706	412.00	47.41	364.59
7	028-370-3706	0.00	15.49	-15.49
8	039-370-3706	600.00	112.68	487.32
9	044-370-3706	2,857.00	494.62	2,362.38
10	053-370-3706	10,000.00	11,234.54	-1,234.54
11	054-370-3706	250.00	74.17	175.83
12	099-370-3706	5,465.00	1,181.15	4,283.85
13	101-370-3706	500.00	40.58	459.42
		<hr/>	<hr/>	<hr/>
** 1 of 1 **		45,134.00	62,163.47	-17,029.47

Enter 'P' for Previous Screen, "Account Index" for Detailed Budget Inquiry, or  
'X' to Exit: \_\_\_\_\_

---

58

*Tom Green County  
Security Report*

- 1) Security Report
- 2) Market Values (Various)

59

FY 2002 Investment Report

Total All Securities All Funds

\$0.00	Interest Received This Month	\$2,187.60	Change In Market Value This Month vs. Last Month
\$0.00	Principal Received This Month	\$3,620.69	Change In Book Value This Month vs. Last Month
\$0.00			

				9/30/2001	9/30/2002		45	Unrealized Life of Sec.	Unrealized
History		Original Price	Accretion(Decretion)	Book Value	Market Value	Received Interest	Accrued Interest	Incl all Interest Gain/(Loss)	Market vs Book Gain/(Loss)
FY 01	August 2001	\$991,816.30	\$0.00	\$989,741.38	\$1,017,500.00	\$92,925.08	\$21,781.77	\$142,465.47	\$27,758.62
FY 01	September 2001	\$991,816.30	\$3,620.69	\$993,362.07	\$1,043,130.00	\$120,295.77	\$5,679.35	\$175,743.05	\$40,767.93
FY 02	October 2001	\$991,816.30	\$0.00	\$993,362.07	\$1,047,500.00	\$120,295.77	\$9,938.86	\$184,372.68	\$54,137.93
FY 02	November 2001	\$991,816.30	\$0.00	\$993,362.07	\$1,038,281.25	\$120,295.77	\$13,811.14	\$179,026.09	\$44,319.18
FY 02	December 2001	\$991,816.30	\$0.00	\$993,362.07	\$1,032,656.25	\$120,295.77	\$17,812.50	\$177,402.45	\$39,229.18
FY 02	January 2002	\$991,816.30	\$0.00	\$993,362.07	\$1,031,562.50	\$120,295.77	\$22,330.16	\$160,226.88	\$36,207.93
FY 02	February 2002	\$1,491,816.30	\$0.00	\$1,493,362.07	\$1,534,793.75	\$144,045.77	\$2,077.47	\$187,554.92	\$43,431.68
FY 02	March 2002	\$1,491,816.30	\$0.00	\$1,493,362.07	\$1,515,906.25	\$144,045.77	\$7,609.83	\$174,199.78	\$22,544.18
FY 02	April 2002	\$1,491,816.30	\$0.00	\$1,493,362.07	\$1,529,937.50	\$144,045.77	\$13,922.16	\$189,543.36	\$30,576.43
FY 02	May 2002	\$1,491,816.30	\$0.00	\$1,493,362.07	\$1,530,837.50	\$144,045.77	\$19,910.12	\$201,431.32	\$37,476.43
FY 02	June 2002	\$1,491,816.30	\$0.00	\$1,493,362.07	\$1,536,493.75	\$144,045.77	\$25,642.98	\$212,620.45	\$43,131.68
FY 02	July 2002	\$1,491,816.30	\$0.00	\$1,493,362.07	\$1,544,556.25	\$144,045.77	\$31,630.94	\$223,100.87	\$51,944.83
FY 02	August 2002	\$1,491,816.30	\$0.00	\$993,362.07	\$1,041,562.50	\$178,945.77	\$2,065.22	\$229,211.42	\$48,200.43
FY 02	September 2002	\$1,491,816.30	\$3,620.69	\$996,982.76	\$1,043,750.00	\$167,795.77	\$5,937.50	\$220,500.51	\$45,767.24

The County's Maintains a passive Investment strategy.

With interest rates as they are, with safety in mind, diversification is taking a higher priority than that of yield.

68

FY 2002 Investment Report

Vocabulary

Accretion	The process to increase book value to equal original face value. (Discount)
Accrued Interest	Interest Due County but not paid until next coupon date.
Decretion	The process to decrease book value to equal original face value. (Premium)
Unrealized Gain/(Loss)	The value of the security held <u>IF</u> it was sold on a particular date.
Book Value	What your books show the value of the security is.
Market Value	What the liquidation value is.

General Information on Security

Broker- Legg-Mason \*\* Purchased 02/22/02 FHLMC with General Fund Money \*\* Cusip # 3129246D0 \*\* Matures 08/22/05 \*\* Purchased Rate/Yield 4.46%  
Callable 08/22/02 No Premium or Discount Paid Coupon Date 08/22/02

\$0.00	Interest Received This Month	\$0.00	Change In Market Value This Month vs. Last Month
\$0.00	Principal Received This Month	\$0.00	Change In Book Value This Month vs. Last Month

								Unrealized Life of Sec.	Unrealized
								Incl all Interest	Market vs Book
								Gain/(Loss)	Gain/(Loss)
History	Original Price	Accretion(Decretion)	Book Value	Market Value	Received Interest	Accrued Interest			
FY 01 August 2001	\$0.00	\$0.00	\$0.00	\$0.00	\$0.00	\$0.00		\$0.00	\$0.00
FY 01 September 2001	\$0.00	\$0.00	\$0.00	\$0.00	\$0.00	\$0.00		\$0.00	\$0.00
FY 02 October 2001	\$0.00	\$0.00	\$0.00	\$0.00	\$0.00	\$0.00		\$0.00	\$0.00
FY 02 November 2001	\$0.00	\$0.00	\$0.00	\$0.00	\$0.00	\$0.00		\$0.00	\$0.00
FY 02 December 2001	\$0.00	\$0.00	\$0.00	\$0.00	\$0.00	\$0.00		\$0.00	\$0.00
FY 02 January 2002	\$0.00	\$0.00	\$0.00	\$0.00	\$0.00	\$0.00		\$0.00	\$0.00
FY 02 February 2002	\$500,000.00	\$0.00	\$500,000.00	\$501,200.00	\$0.00	\$371.67		\$371.67	\$200.00
FY 02 March 2002	\$500,000.00	\$0.00	\$500,000.00	\$494,500.00	\$0.00	\$2,230.00		\$2,230.00	\$1,300.00
FY 02 April 2002	\$500,000.00	\$0.00	\$500,000.00	\$500,250.00	\$0.00	\$4,212.22		\$4,212.22	\$2,500.00
FY 02 May 2002	\$500,000.00	\$0.00	\$500,000.00	\$501,150.00	\$0.00	\$6,132.50		\$6,132.50	\$3,800.00
FY 02 June 2002	\$500,000.00	\$0.00	\$500,000.00	\$501,650.00	\$0.00	\$7,928.89		\$7,928.89	\$5,300.00
FY 02 July 2002	\$500,000.00	\$0.00	\$500,000.00	\$501,900.00	\$0.00	\$9,849.17		\$9,849.17	\$6,200.00
FY 02 August 2002	\$500,000.00	\$0.00	\$0.00	\$0.00	\$11,150.00	\$0.00		\$11,150.00	\$0.00
FY 02 September 2002	\$500,000.00	\$0.00	\$0.00	\$0.00	\$0.00	\$0.00		\$0.00	\$0.00

The County's Maintains a passive Investment strategy.  
With interest rates as they are, with safety in mind, diversification is taking a higher priority than that of yield.

# FY 2002 Investment Report

## Vocabulary

Accretion	The process to increase book value to equal original face value. (Discount)
Accrued Interest	Interest Due County but not paid until next coupon date.
Decretion	The process to decrease book value to equal original face value. (Premium)
Unrealized Gain/(Loss)	The value of the security held <u>IF</u> it was sold on a particular date.
Book Value	What your books show the value of the security is.
Market Value	What the liquidation value is.

## General Information on Security

Broker- Prudential \*\* Purchased 04/27/99 US Treasury with General Fund Money \*\* Cusip # 9128275A6C \*\* Matures 02/15/04 \*\* Purchased Rate/Yield 5.164%  
At purchase we paid accrued interest \$9,316.30 and received of discount \$17,500.00

\$0.00 Interest Received This Month	\$2,157.50 Change In Market Value This Month vs. Last Month
\$0.00 Principal Received This Month	\$3,620.69 Change In Book Value This Month vs. Last Month

9128275A6C		9/30/2002		3/30/2002		4/6/02		Unrealized Life of Sec.	Unrealized
History	Original Price	Accretion(Decretion)	Book Value	Market Value	Received Interest	Accrued Interest	Incl all Interest	Gain/(Loss)	Market vs Book
FY 01 August 2001	\$991,816.30	\$0.00	\$989,741.38	\$1,017,500.00	\$92,925.08	\$21,781.77	\$1,122,155.23	\$122,155.23	\$22,758.52
FY 01 September 2001	\$991,816.30	\$3,620.69	\$993,362.07	\$1,043,130.00	\$120,295.77	\$5,679.35	\$1,152,755.35	\$152,755.35	\$28,757.93
FY 02 October 2001	\$991,816.30	\$0.00	\$993,362.07	\$1,047,500.00	\$120,295.77	\$9,938.86	\$1,162,572.50	\$162,572.50	\$28,757.93
FY 02 November 2001	\$991,816.30	\$0.00	\$993,362.07	\$1,038,281.25	\$120,295.77	\$13,811.14	\$1,176,378.00	\$176,378.00	\$28,757.93
FY 02 December 2001	\$991,816.30	\$0.00	\$993,362.07	\$1,032,656.25	\$120,295.77	\$17,812.50	\$1,194,190.50	\$194,190.50	\$28,757.93
FY 02 January 2002	\$991,816.30	\$0.00	\$993,362.07	\$1,031,562.50	\$120,295.77	\$22,330.16	\$1,216,520.66	\$216,520.66	\$28,757.93
FY 02 February 2002	\$991,816.30	\$0.00	\$993,362.07	\$1,033,593.75	\$144,045.77	\$1,705.80	\$1,262,345.20	\$262,345.20	\$28,757.93
FY 02 March 2002	\$991,816.30	\$0.00	\$993,362.07	\$1,021,406.25	\$144,045.77	\$5,379.83	\$1,272,431.85	\$272,431.85	\$28,757.93
FY 02 April 2002	\$991,816.30	\$0.00	\$993,362.07	\$1,029,687.50	\$144,045.77	\$9,709.94	\$1,282,141.74	\$282,141.74	\$28,757.93
FY 02 May 2002	\$991,816.30	\$0.00	\$993,362.07	\$1,029,687.50	\$144,045.77	\$13,777.62	\$1,295,919.36	\$295,919.36	\$28,757.93
FY 02 June 2002	\$991,816.30	\$0.00	\$993,362.07	\$1,034,843.75	\$144,045.77	\$17,714.09	\$1,313,633.45	\$313,633.45	\$28,757.93
FY 02 July 2002	\$991,816.30	\$0.00	\$993,362.07	\$1,042,656.25	\$144,045.77	\$21,781.77	\$1,335,415.22	\$335,415.22	\$28,757.93
FY 02 August 2002	\$991,816.30	\$0.00	\$993,362.07	\$1,041,562.50	\$167,795.77	\$2,065.22	\$1,505,213.22	\$505,213.22	\$28,757.93
FY 02 September 2002	\$991,816.30	\$3,620.69	\$996,982.76	\$1,043,750.00	\$167,795.77	\$5,937.50	\$1,521,500.51	\$521,500.51	\$28,757.93

The County's Maintains a passive Investment strategy.

With interest rates as they are, with safety in mind, diversification is taking a higher priority than that of yield.

62

Page

P065 Client RPT

Type 0 <PAGE> to view currency cross rate information.

10/ 1 08:10

# PORTFOLIO DISPLAY

PAGE 3 / 3

Holder Name DREHER INVESTMENT SERVICES, IN

Portfolio Currency:US

Port Name: TOM GREEN COUNTY

Port U121365-7

Filing Date 8/11/00

Cash (x000):

Rate:

Security	Position	Price As 9/ 2/02	Price As 9/30/02	Principal 9/30/02	Change
DT 4 ¾ 02/15/04 US	1000	104 ½ BGN	104 ¾ BGN	1,043.75M	2,187.50
ZFHLMC 4.46 08/05 US	500				

Australia 61 2 9777 8600

Brazil 5311 3048 4500

Europe 44 20 7330 7500

Germany 49 69 920410

Hong Kong 852 2377 6000 Japan 81 3 3201 8900 Singapore 65 212 1000 U.S. 1 212 318 2000

Copyright 2002 Bloomberg L.P.  
0659-321-1 01-Oct-02 8:11:24

**Bloomberg**  
TERMINAL

63

VOL. 75 PG. 552



OCT-1-2002 08:52 FROM:DREHER COMPANY INC 9154878700

TO:96596440

P:3/3

5

P065 Govt SXT

Enter <1><GO> to send screen via <MESSAGE> System.

10/ 1/2002 08:14

TRADE TICKET

AS OF: 10/ 1/02

ISIN US9128275A61

9128275A6

DATED 2/15/99

TRADER DREHER SERVICES  
At DREHER INVESTMENT SERVICES, INC.

SELL 1000 M OF T 4 02/15/04

MIN PIECE: 1000

\* US TREASURY N/B \*

PRICE 104-12 YIELD 1.521453 to Worst 2/15/04 100  
(104.3750000)

SETTLEMENT ON 9/30/02

NOTES:

(9128275A Govt DES<GO>)

VIEW AMOUNTS IN USD @ 1.000000000 (US /US ) INVERT? Highlights off? N

### TRADE NUMBERS

PRINCIPAL	\$	1,043,750.00
ACCRUED ( 46 DAYS )		5,937.50
TOTAL	\$	1,049,687.50

Australia 61 2 5777 8600

Brazil 55 11 3048 4500

Europe 44 20 7228 7500

Germany 49 69 920410

Hong Kong 852 2577 6000

Japan 81 3 3201 8900

Singapore 65 212 1000

U.S. 1 212 318 2000

Copyright 2002 Bloomberg L.P.

6659-321-1 01-Oct-02 8:16:33

Bloomberg  
PROFESSIONAL

64

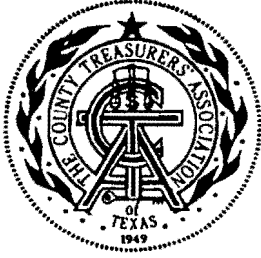

*Dianna Spieker CCT, CIO*

*Certified County Treasurer (CCT)*

*Certified Investment Officer (CIO)*

*Tom Green County Treasurer*

*113 W Beauregard*

*San Angelo, TX 76903*

*(915) 659-3263 (915) 659-6440 (fax)*

*Email dianna.spieker@co.tom-green.tx.us*

Commissioners' Court

REF: Treasurer / Investment Officer's Annual Report Fiscal Year 2002

County Judge Mike Brown (Investment Committee Member)

Commissioner Pct. 1 Clayton Friend

Commissioner Pct. 2 Karl Bookter (Investment Committee Member-Dec 2001)

Commissioner Pct. 3 Jodie Weeks (Investment Committee Member)

Commissioner Pct. 4 Richard Easingwood

As per the attached page of Tom Green County's Investment Policy for the period of October 1, 2001 to September 30, 2002 I submit the FY02 Annual Security Report.

The County maintained a passive investment portfolio. My priority as Investment Officer is to maintain Safety, Liquidity, Diversification, Yield, and Maturity. In doing so all monies with the exception of Two (2) Securities were kept in MBIA and Funds Management. This allowed the County to earn the highest yield possible while having daily liquidity availability. In accordance to Safety MBIA pledges 102% collateral as well as a letter of credit from their bank to assure our Principal safety. MBIA post interest daily, therefore today's interest becomes tomorrow's principal. Tom Green County owns shares in Funds Management investment portfolio, which is backed by the US Government.

Tom Green County owned "FHLMC Callable Cusip 3129246D0 matures 08/22/05 Broker Legg-Mason General Fund", until 08/22/02 at which time this security was called. The remaining security owned "US Treasury Cusip 9128275A6C matures 04/27/04 Broker Prudential General Fund" will be held until maturity unless otherwise directed by the Commissioners' Court in a regular meeting and documented in the Courts' Minutes. For more detailed information on these securities please refer to the Treasurer's Monthly Reports.

In the past all funds were transferred out of Texas State Bank into MBIA or Funds Management to maximize our interest earnings. However, the interest rates did not change much to our benefit, therefore, more money was maintained in the checking accounts to take advantage of the Depository Bid contract, which guarantees a 3.75% interest rate. I will be weighing the amount carefully as the down side of leaving our money in the checking will cost more in Service charges. I will also maintain my Diversification strategy according to the PFIA.

In closing, I submit the FY02 Annual Report for your review and acceptance.

Dianna Spieker  
County Treasurer  
Investment Officer

Cc: County Clerk  
Investment Committee

RFP 02-015 "Cellular Service" SpreadSheet- Sept.30, 2002

Description	West Central Cellular	Cellular One	NEXTEL Partners Inc.	Nextel
Monthly Access	\$ 17.95	\$ 27.07	\$14.18 + \$0.18 per minute for Cellular	\$ 48.49
Additional Minutes	.20/min	.39/ per minute	.35/min	Not Complete
Monthly Detailed Billing	no charge		no charge	
Monthly Master Billing	no charge			
Minute sharing	yes All Minutes Pooled Accordingly	yes	yes \$5.00 per unit	
Roaming Charges	In the state between .40 - .60 Texas Home Feature may be added: \$10.00 /mo 30 minutes \$25.00/ mo 90 minutes \$50.00/ mo 200 minutes	.59 per minute Roaming Calls placed from Within coverage Area to states other than TX .10 per minute Calls placed from outside coverage Area are billed at .10 per minute Toll	n/a	
Features	Choose One Package Blue Package-Caller ID, Call Forwarding, Conf. Calling, Call Waiting, Detailed Billing  Orange Package- USA Free, Call Diversion, Basic Voice Mail, Call Waiting, Conf. Calling Detailed Billing	Enhanced Voice Mail, Mail List (group calling) Message retrieval, initial set-up fee waived, Call Forwarding, Call waiting, Conf. Calling, Three Way Calling, Caller ID, Detailed Billing, 1750 Night Minutes, 1750 weekend minutes Long Distance calls placed within TX ,NM, OK CellularOne serv.Area are no charge to TX		
Special Incentives	Free Digital Phones w/accessories Exclusive Six-second billing adds an additional 20-25% increase in minutes when compared to companies that round up to a full minute of use.	Short Meassge Service	10% County Discount	
Activation Fee	NO charge	Waived		
est. Total minutes	Analog Phones (based on 20 phones) Anytime minutes 2000 Dig. Phones (based on 62 phones) Anytime minutes 12,400 Night/Weekend minutes 12,400 Mobile to moblie unlimited	All 82 phones Pool 26,180 min per month 314,160 annually		
Est. Monthly Cost	\$ 1,472.90	\$ 2,220.00	\$ 3,515.06	\$ 3,927.69
Est. Yearly Cost	\$ 17,674.80	\$ 26,640.00	\$ 45,190.32	\$ 47,132.28